

Interfaces between Main Injector Tunnel and the LBNF Extraction Enclosure

Matthew A. Sawtell

04OCT19

Background

- There has been rudimentary understanding as to what was to interface between the walls between Main Injector and the LBNF Extractor Enclosure, other than the sleeve pipe for the vacuum line of the LBNF Beamline
- With the push to the Preliminary Design of the NSCF for LBNF, there needs to be a better understanding of what is truly needed, and if it can be accommodated into the NSCF Design work

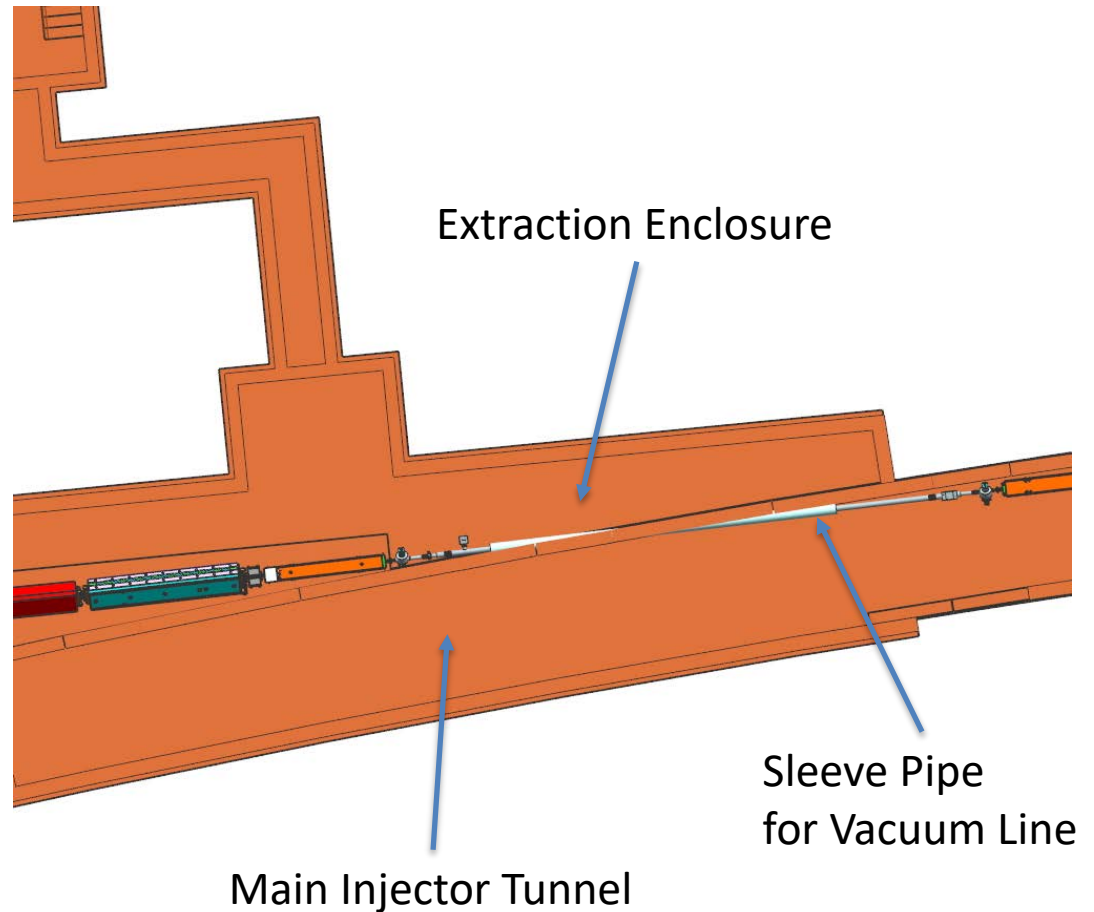

Sight Window for Beamline Alignment – located 1.5 Meters above floor of Main Injector

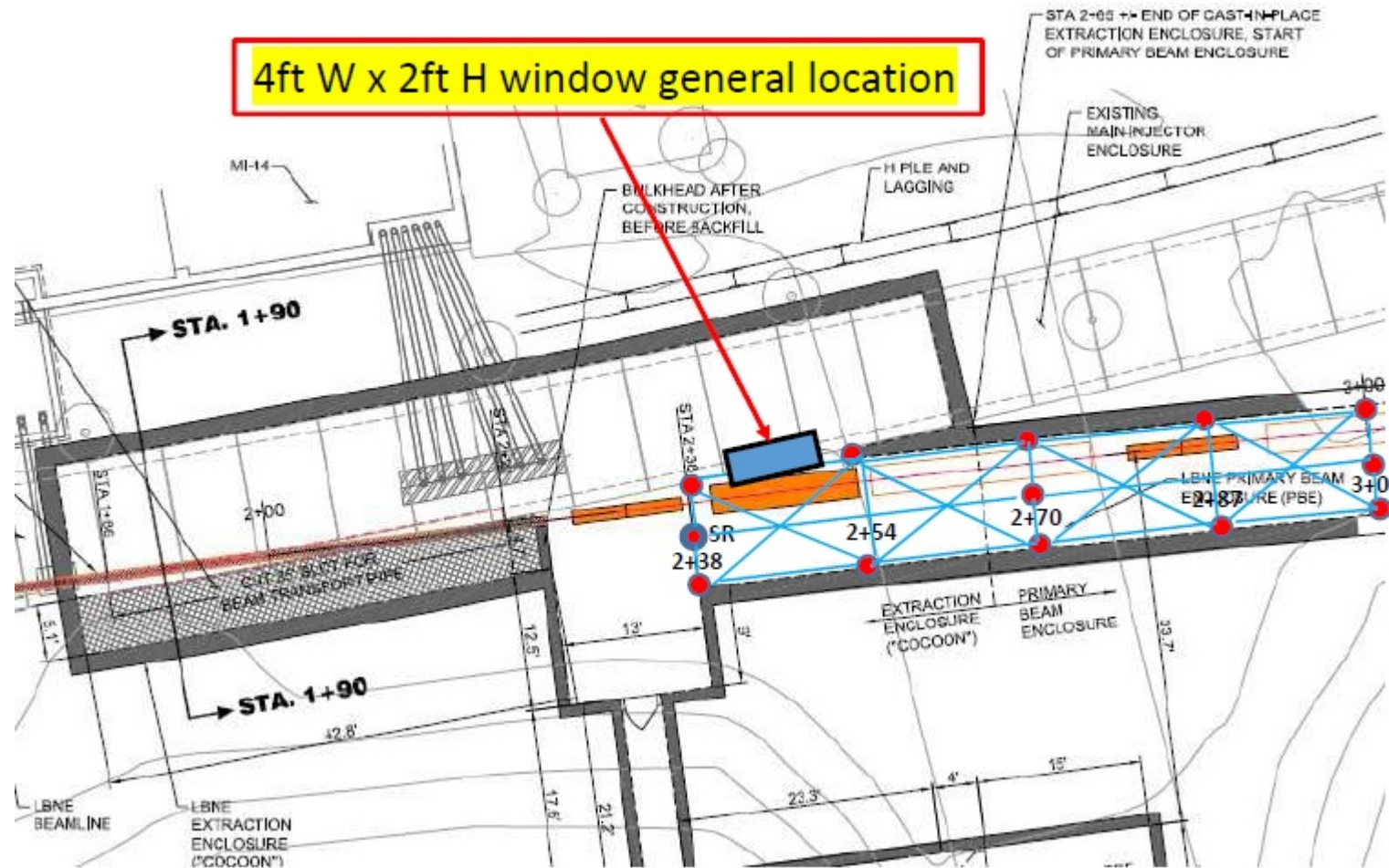

Addition Penetrations Needed?

- LCW Lines?
 - Supply
 - Return
- Communication Lines?
 - ACNET
 - Sensors for LBNF Primary Beamline
- Power Lines?
 - LBNF Primary Beamline
 - Emergency / Backup