

# ProtoDUNE II (PD2) Update

J Fowler and others

# Current protodune II model

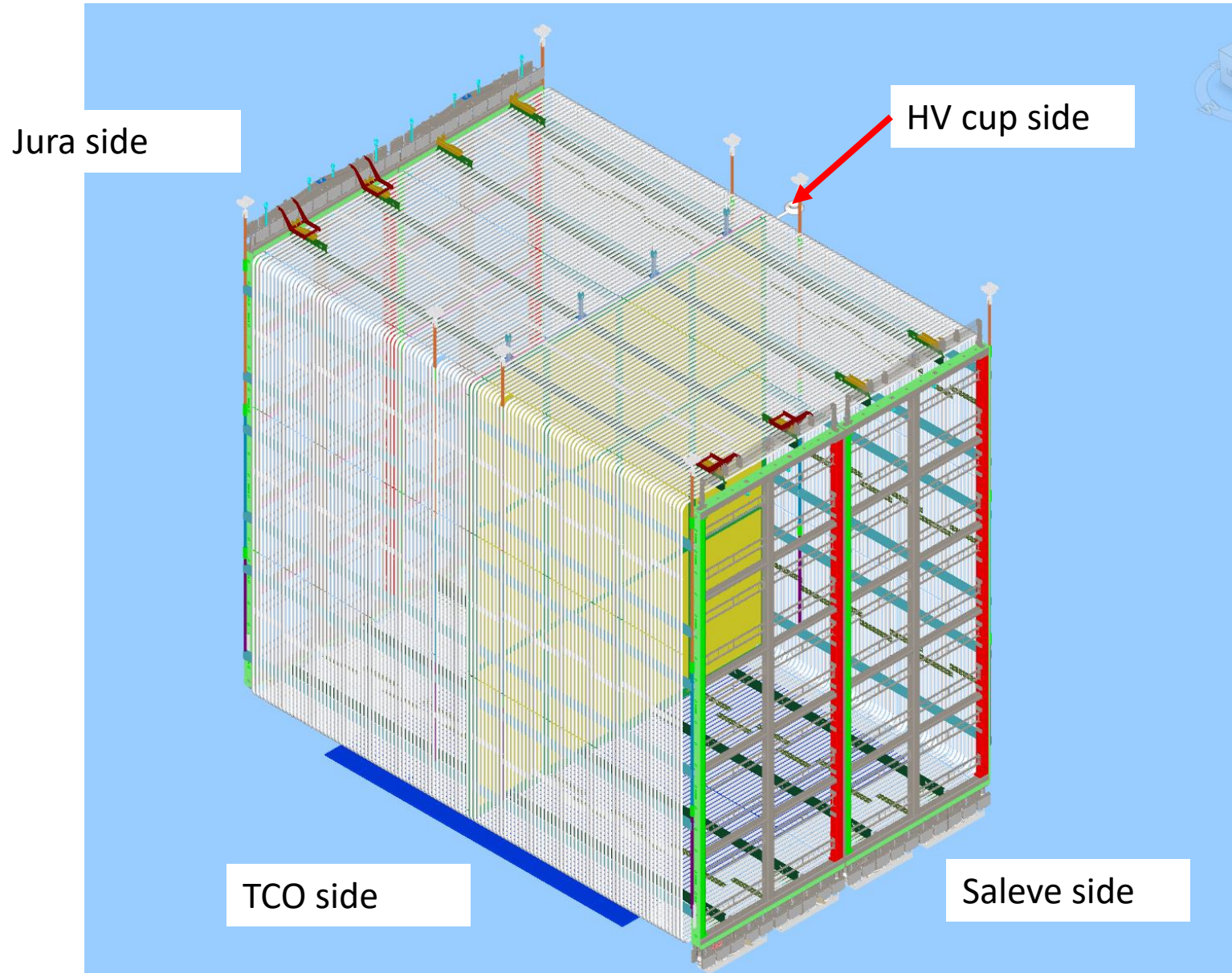

Note: Inverted APAs on the Saleve side



# Placement in X



HV cup side

Distance to wetted membrane surface

TCO SIDE

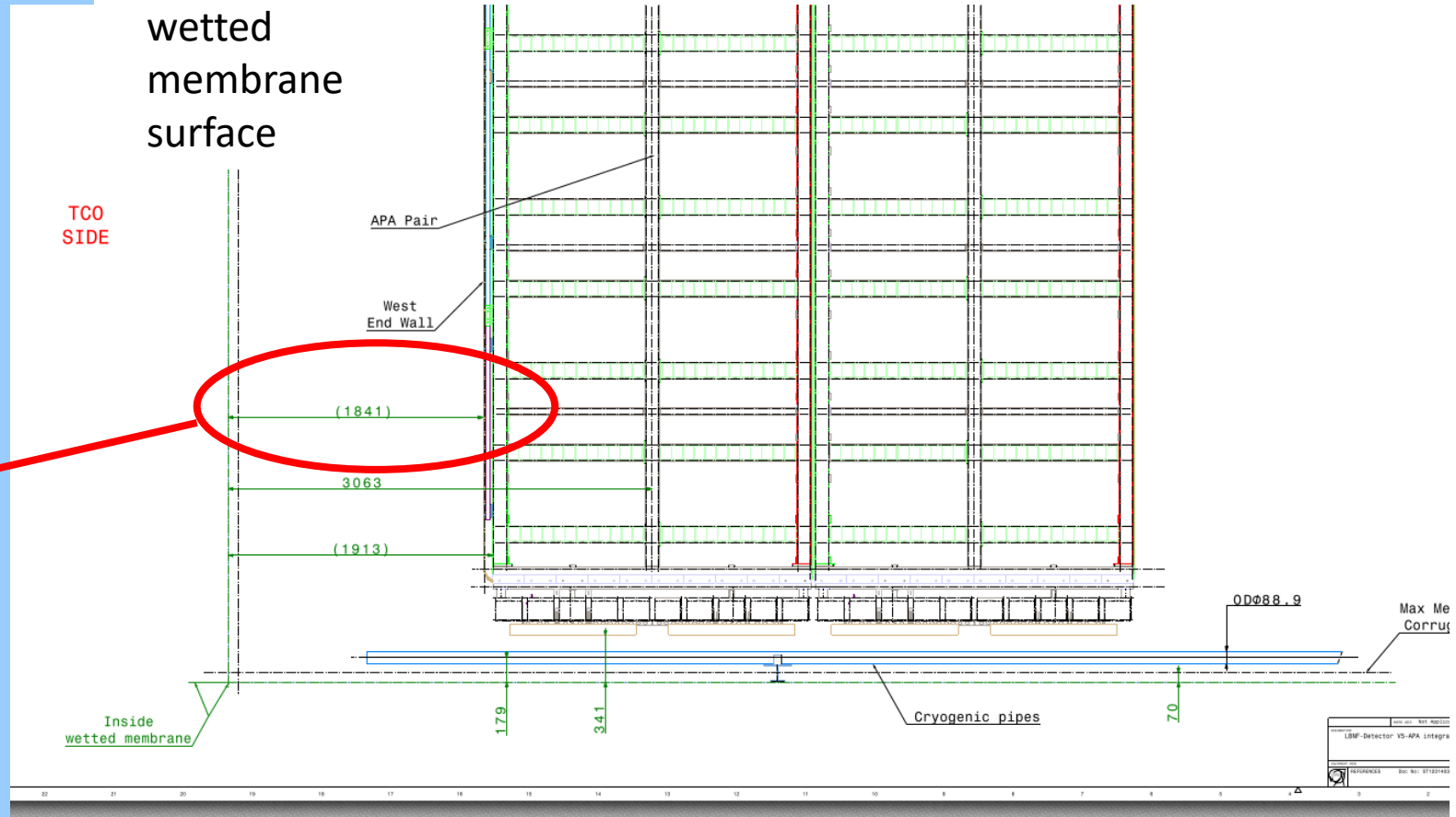

# Z placement

- Match the distance from the top of the yoke to the bottom of the DSS beam and we see where we are

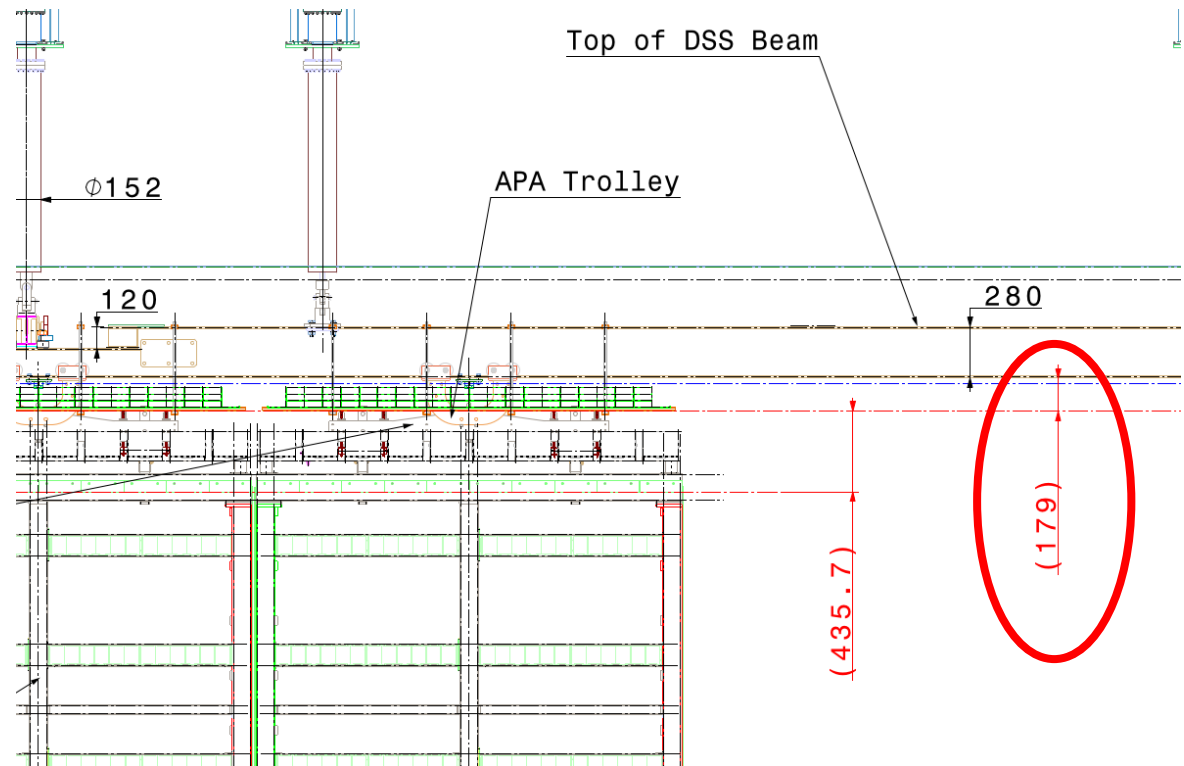

# Sectioned views of current placement

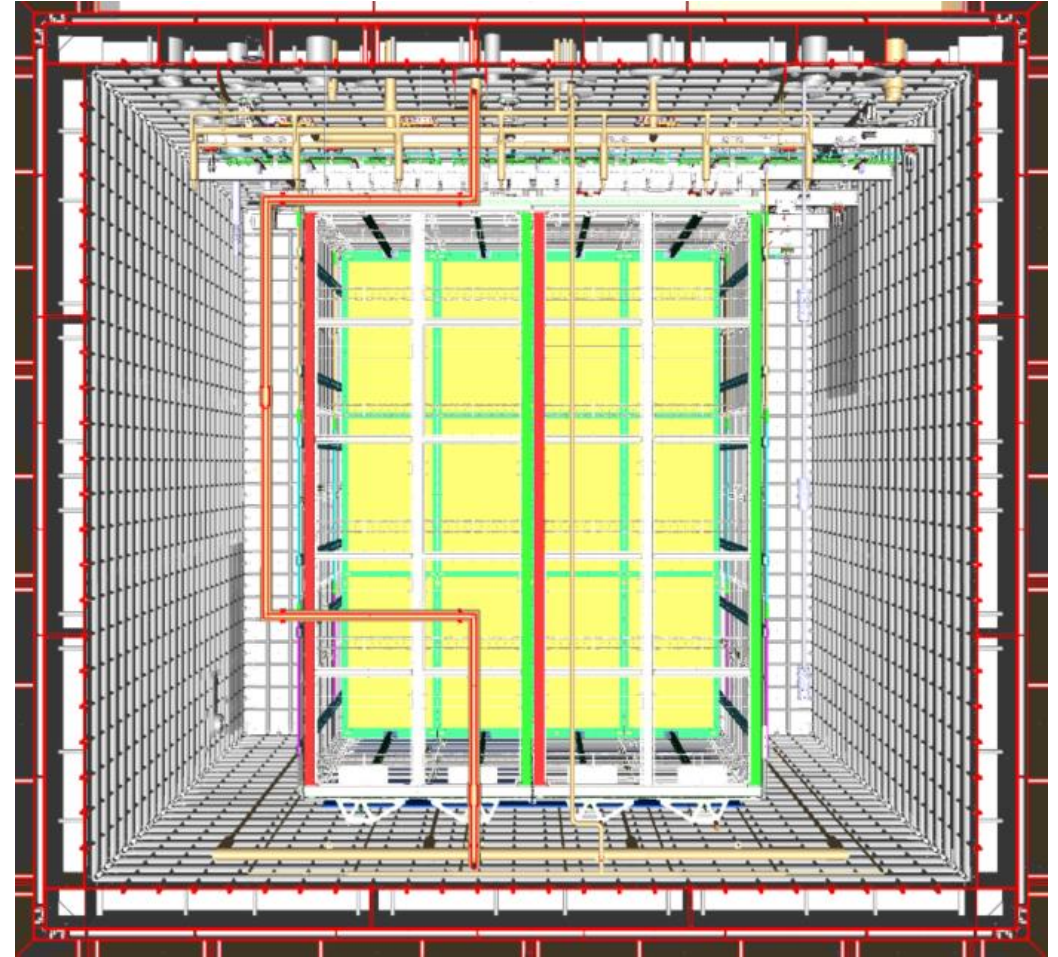
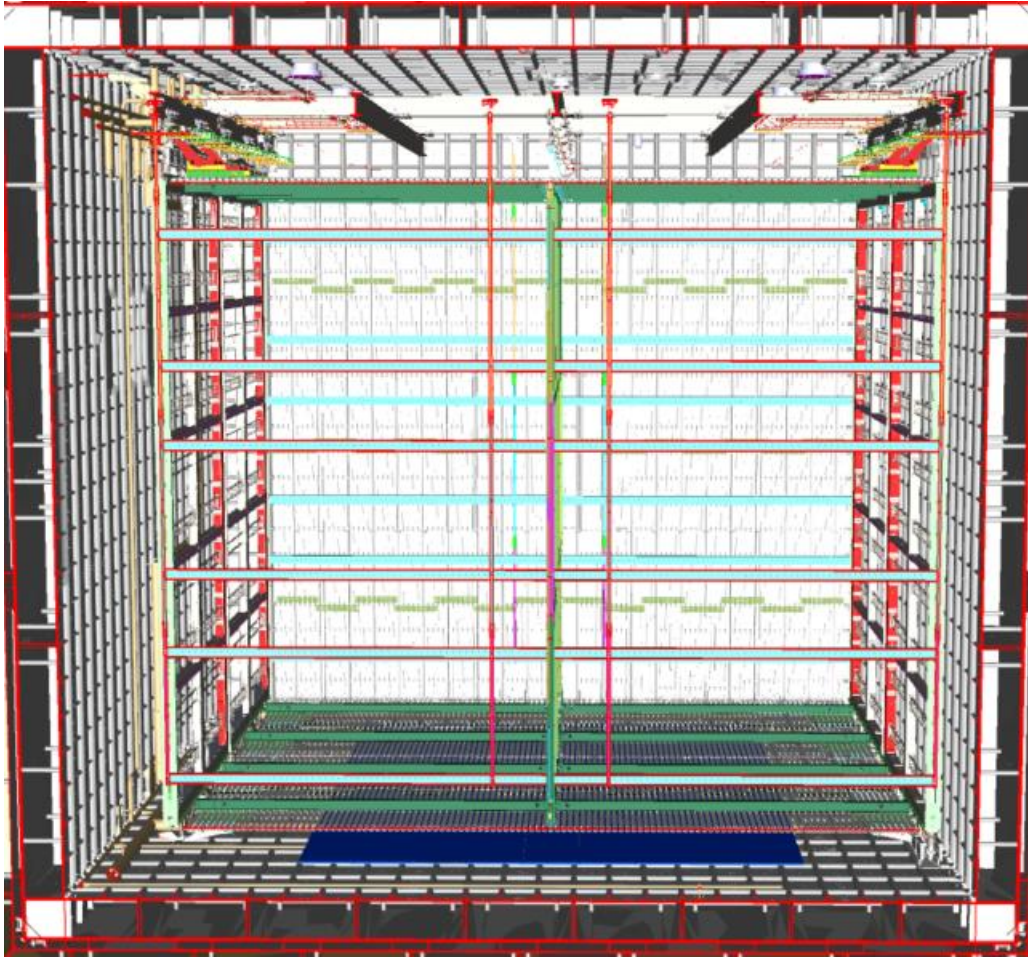

# Offset from PD1 position on Saleve side

- This image shows the DSS in the PD1 position and the detector in the PD2 position. We are in the process of realigning the DSS in the model.

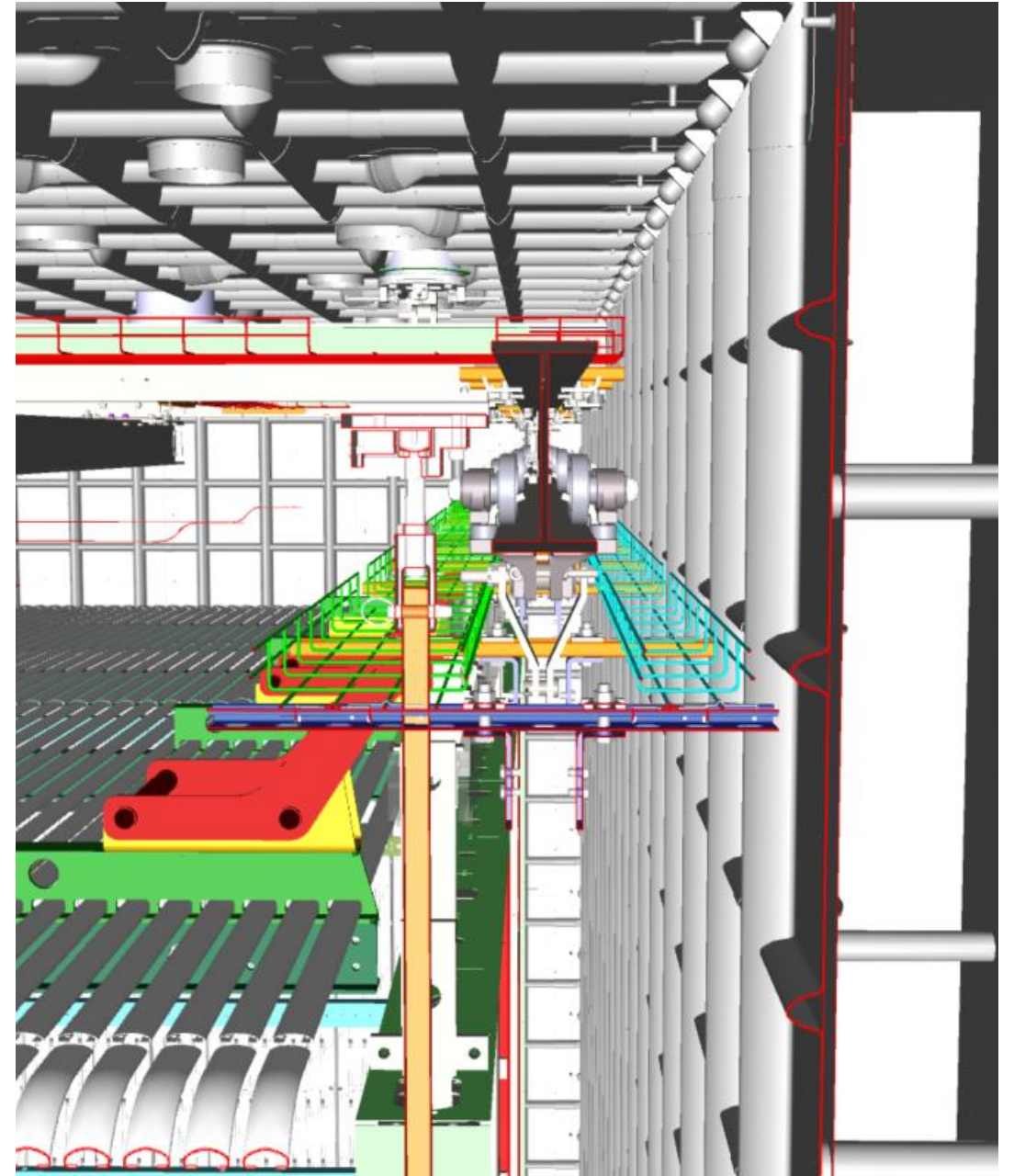

# Alignment on the Jura side

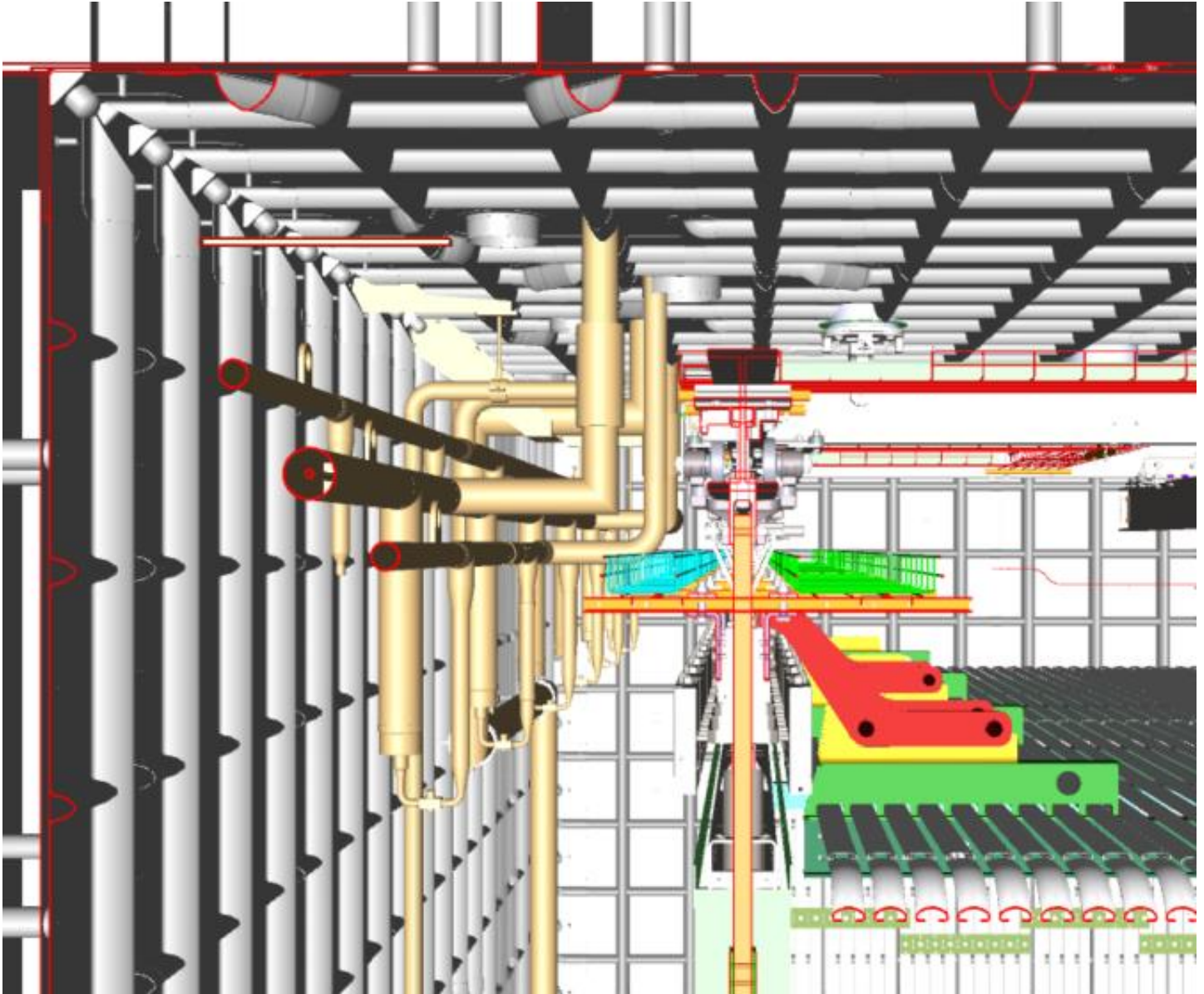



# Items in work

- How to mount the upper ground plane from DSS rails?

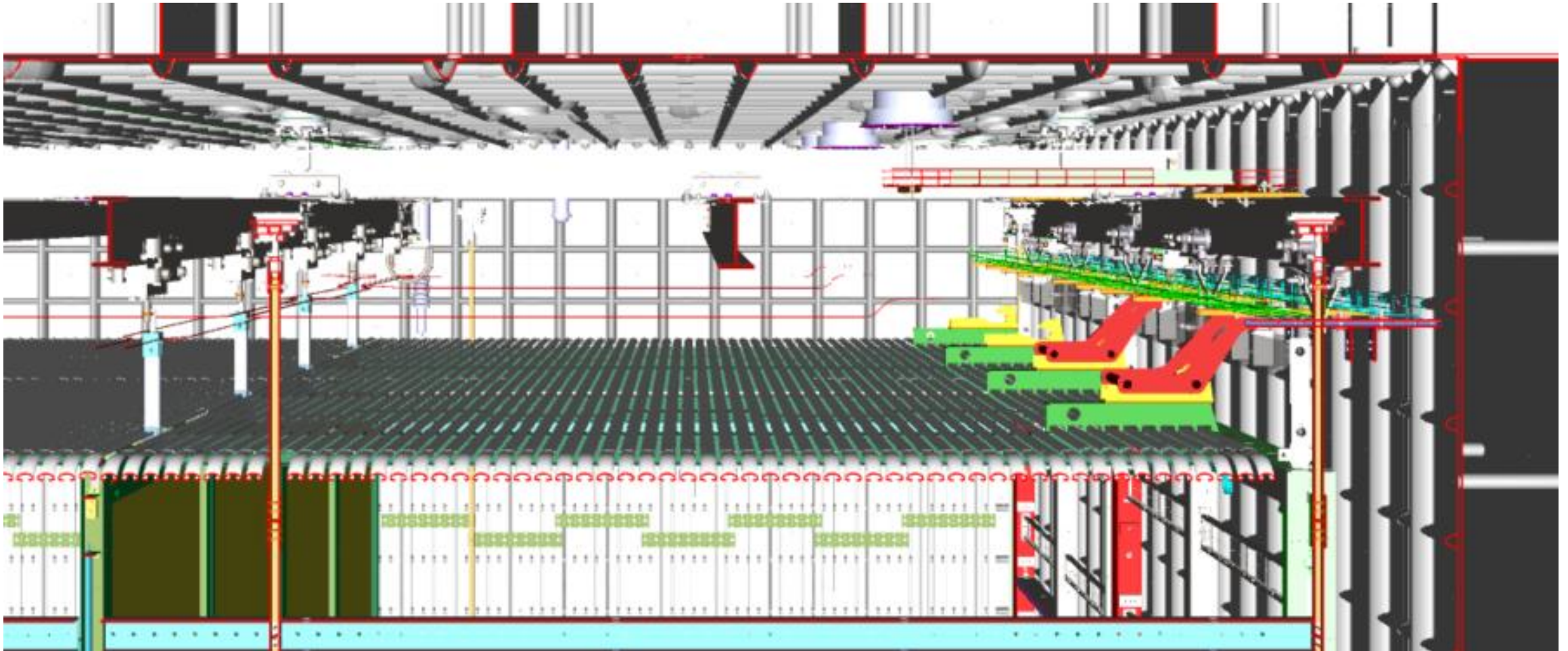

# Finalize feed thru assignments

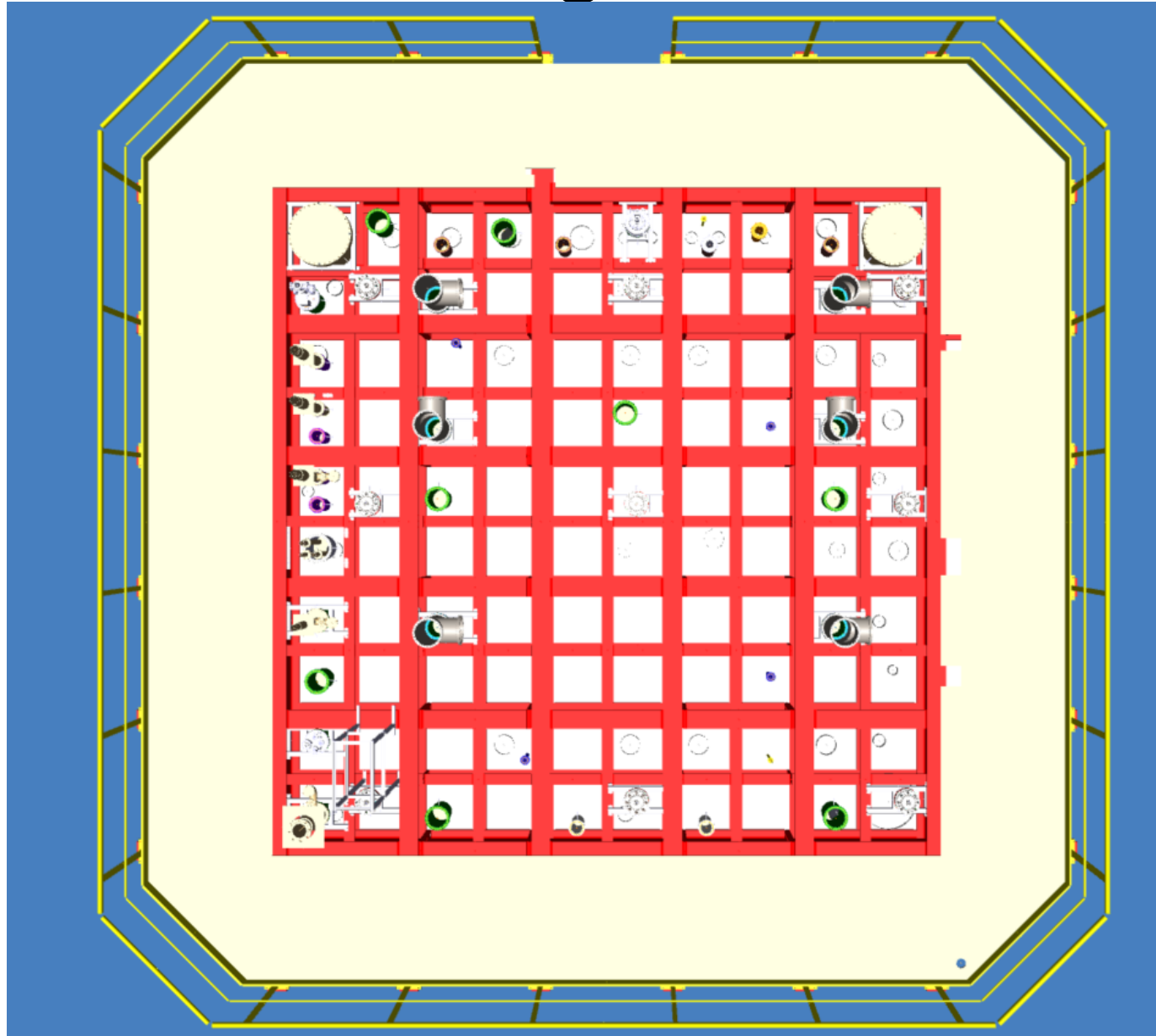

# APA in Cold Box

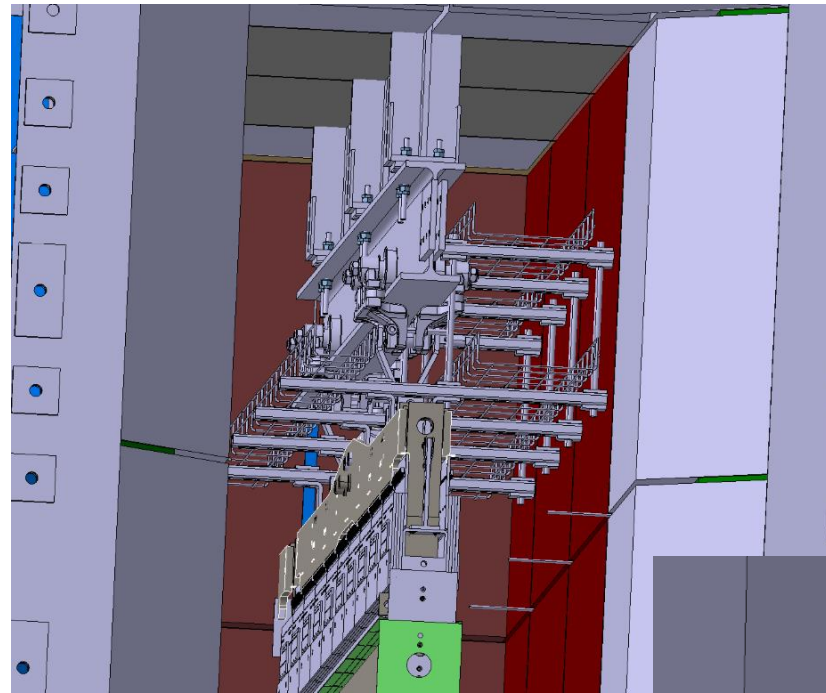
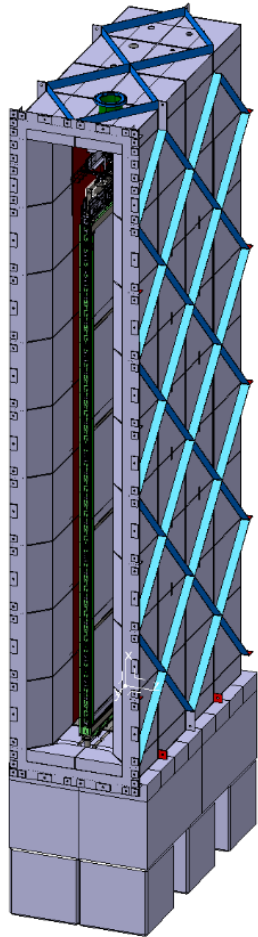

Models at CERN confirm the interference numbers from Kyle. Some of the SS fins in the insulation at the bottom of the cold box will need to be cut away. Determining how much and will move forward.

