

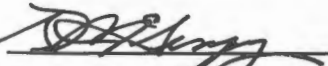

## Search and Secure Procedure:

- 1) "A" and "B" enter the Hall and proceed upstream to the raised floor area, the "Stub". There is a cover over the cable penetration on the far upstream wall. Verify the cover is in place and locked.
- 2) "A" and "B" sweep the area to reset Interlock Box #1.
- 3) "A" and "B" sweep the hall to ①, where "A" holds. "A" uses the Mirror to check on top of the Shielding Cave.
- 4) "B" checks the area between the Shielding Cave and the wall.
- 5) "B" using a flashlight checks inside the Shielding Cave, then joins up with "A".
- 6) "A" and "B" exits the Hall, closing the door behind them.
- 7) "A" and "B" sweep the hallway to Interlock Box #2.
- 8) "A" holds while "B" resets Interlock Box #2.
- 9) "A" and "B" sweep the stairway to the exit, checking under the grating, and exit the enclosure.
- 10) "A" and "B" resets Interlock Box #3.

Reviewed Area RSO	Date
	9/9/20
Approved AD/OPS Dept. Head	Date
	9/9/20

See enclosure map on the previous page

# AD Enclosure - M.T.A.

Search and Secure Procedure

M<sub>ev</sub> T<sub>est</sub> A<sub>rea</sub>  
MTA.V3.0

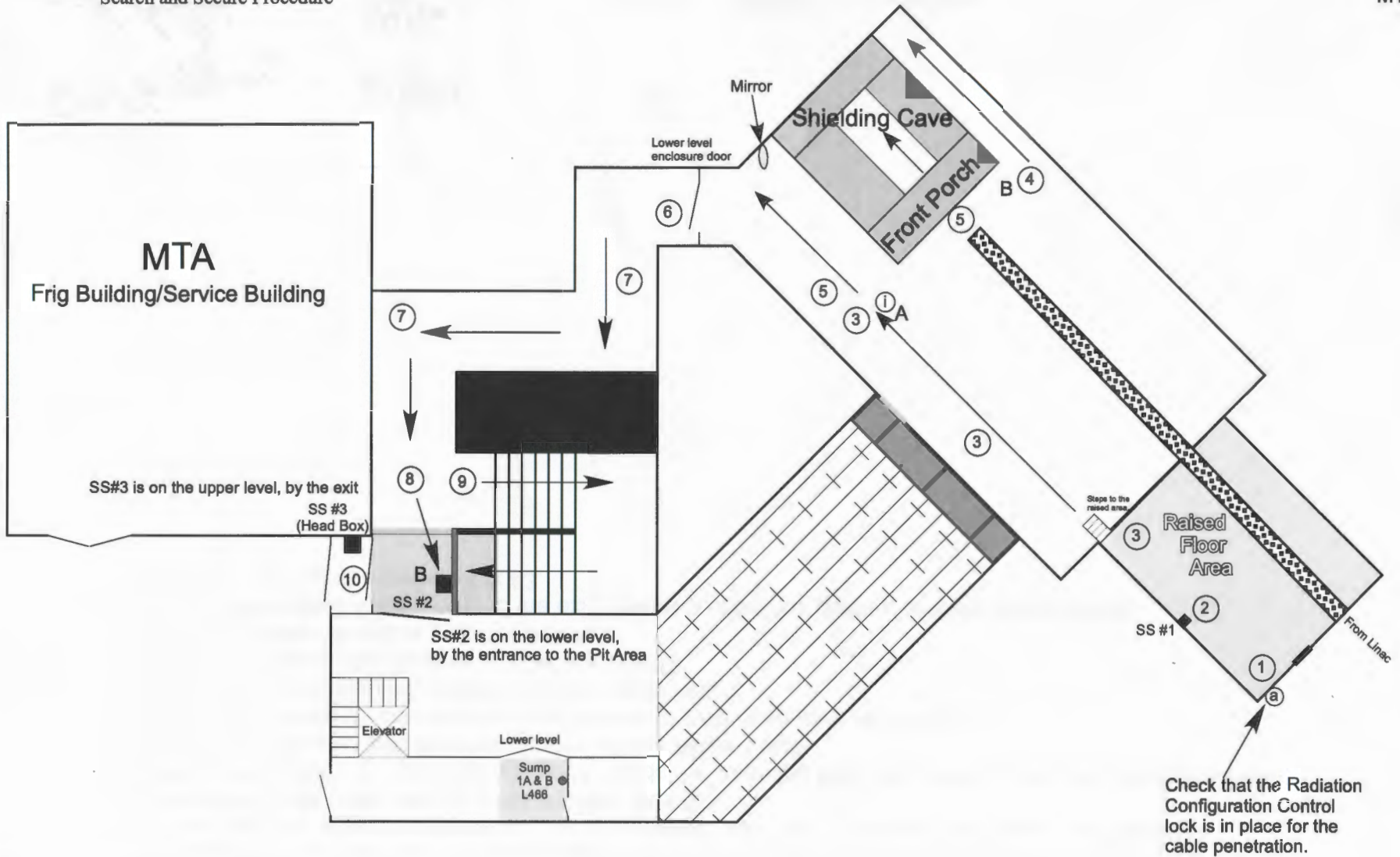

Reviewed Area RSO	Date
<i>[Signature]</i>	9/9/20
Approved AD/OPS Dept. Head	Date
<i>[Signature]</i>	9/9/20

See procedure on the next page  
CONTROLLED DOCUMENT

Users are responsible for ensuring they work to the latest approved revision. Printed or electronically transmitted copies are uncontrolled.