



# Space Team Update

Ray Culbertson, Barb Hehner, Hogan Nguyen  
Muon Dept. Meeting  
August 27, 2020

# Charge

Recommend how to transition the area in front of the east side elevators into a Muon Department Welcome Area and recommend how to best use the area in the south side of 9E. Solicit input from the department on both issues. Help implement changes.



- will include the mailbox and behind-elevators, “overlook” area

# Process

- Continued discussions and updates at Muon Dept. Meetings
- Send survey via email or other means. Please send suggestions at any time..
- Discuss survey results and all suggestions made at the next Muon Dept. Meeting

*The following may need to be delayed until covid restrictions are further lifted*

- Announce final plan based on survey outcome, suggestions, discussions with Fermilab Interior Designer and Graphic Arts Dept., and budget constraints
- Work with Fermilab Interior Designer on furniture purchases
- Work with Graphic Arts Dept. on Welcome Area media (video display or hard copy graphics)

# Suggestions Under Consideration So Far

- Welcome Area (area in front of the WH 9E elevators)
  - Two chairs and small table instead of the two tables there now
    - review what is on the other floors
  - Update media hanging from the ceiling
  - Possible video display with collaboration loop/slide or lab beam status
  - Picture directory
- Mail Station and Overlook Areas
  - Purchase a much smaller mail station.
  - Add a comfortable chair and small table for private space to make phone calls or eat lunch.

# Suggestions Under Consideration So Far

- The “Pit” Area (space across from the Libra Conference Room)
  - Add furniture
  - Paint white walls
  - Store board games
  - Pet collage
  - Bulletin board to post announcements; charity events, local events; local interesting destinations, etc.
- NOTE: The overlook area has to remain a safe environment for electrical components, HVAC, and emergency protocol. Nothing can block the panels. Other signage, width, egress, clearance rules will be checked.

# Upcoming Survey (Draft ideas)

- Should the Welcome Area include a video display with collaboration loop/slide or lab beam status or hard copy graphics to present an overview of Mu2e and g-2?
- Do you want the Welcome Area to include a Dept picture directory?
- The unofficial name of the area across from the Libra Conference Room is the “Pit.” Do you prefer to keep that name, or change it? Name suggestions welcome.
- What functions of the pit area are important: guest work? Conversational? Relaxing?
- If board games were stored in the “Pit” area, would you use them?
- Are you interested in a pet collage posted in the “Pit” area? Basically, a bulletin board with pictures of pets owned by anyone working on Muon Department experiments.
- Are you interested in a bulletin board in the “Pit” area to announce charity events, social events, etc.?
- Add any suggestions

# Stationary Layout

Some drawings from 2015, when The Pit was last updated..

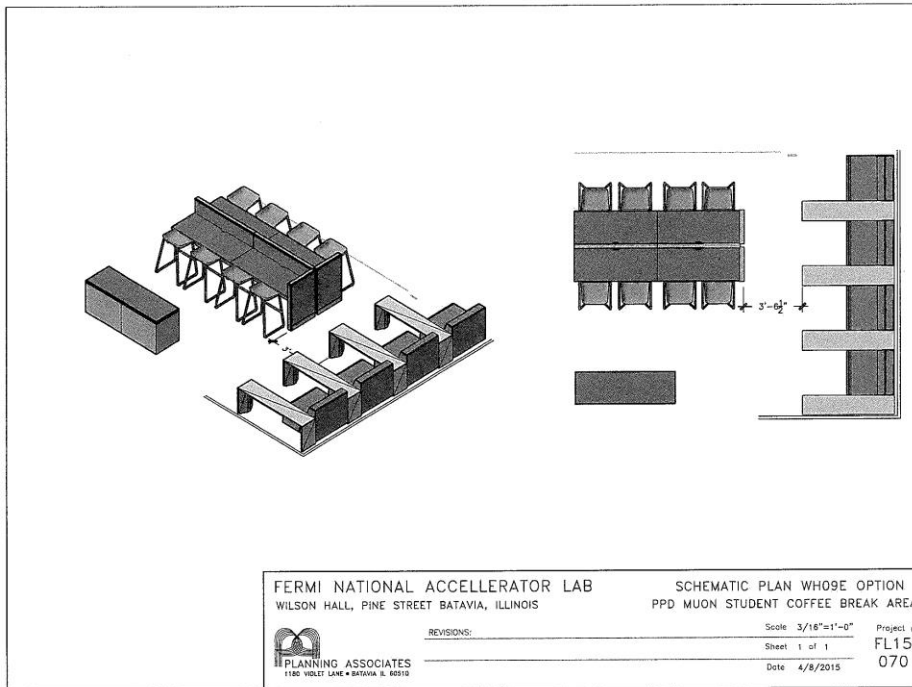

- Useful to get work done
- Seats 10 (our bar height table actually has 6 seats)

# Four Chair Layout

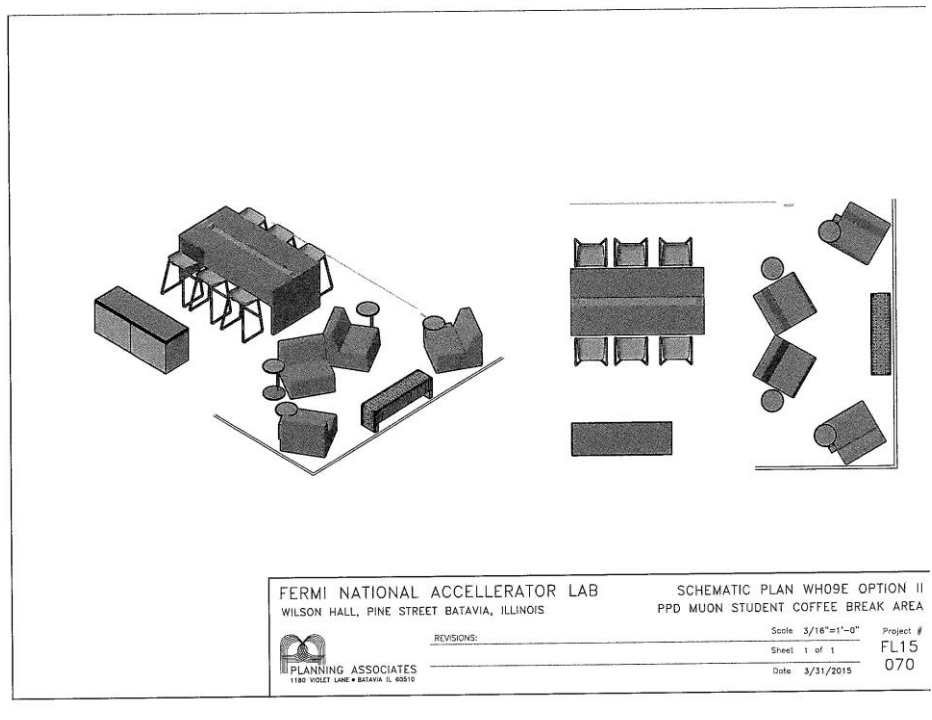

- Useful and comfortable to study and have conversations
- Seats 10



# Six Chair Layout

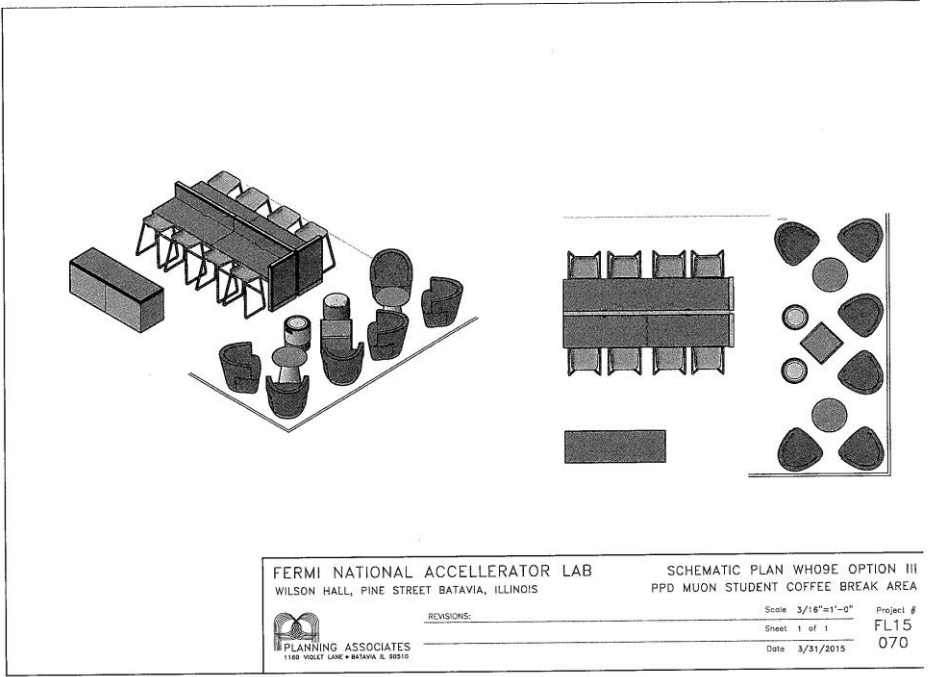

- Useful and comfortable
- Might be tight to get around
- Seats 12

# Four Chair Central Table Layout

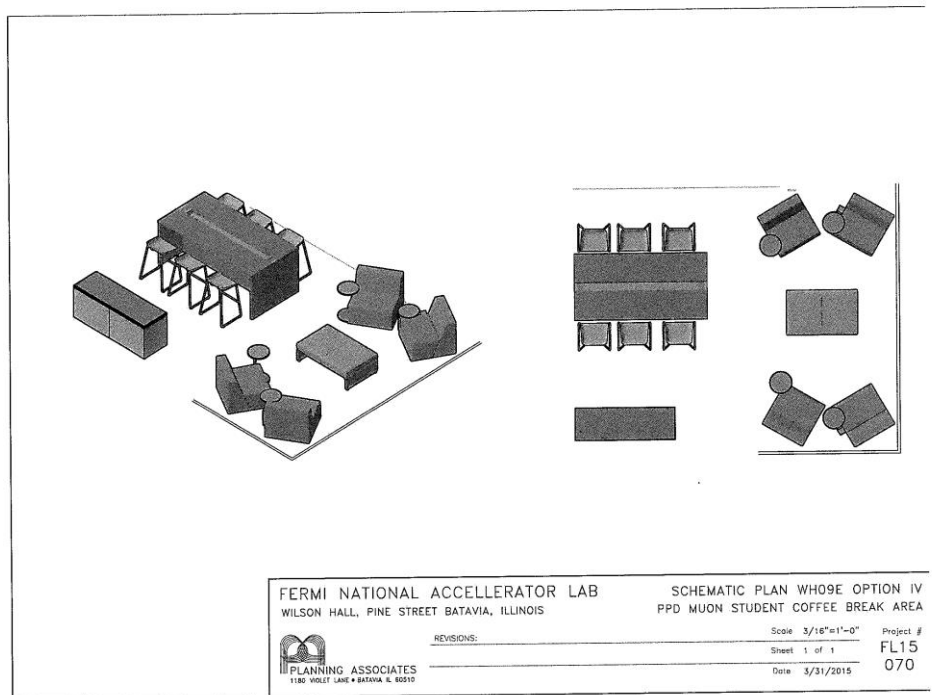

- Useful and comfortable
- Central table helpful to work on shared projects
- Seats 10

# Couch Layout

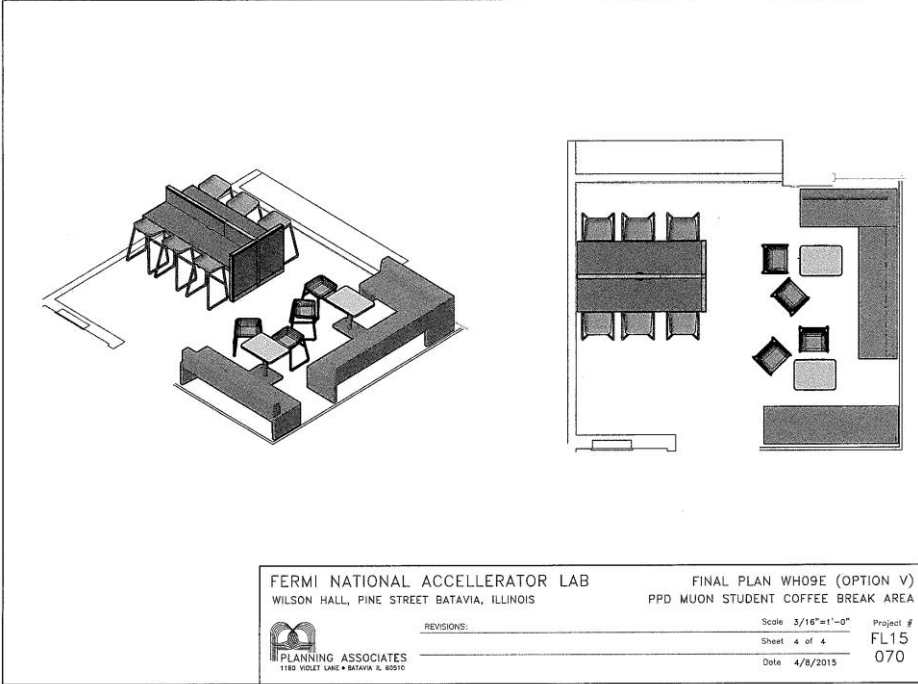

- Useful and comfortable
- Lounge feel to it
- Seats 16 or more

# Any suggestions, ideas, or comments?

