

8 7 6 5 4 3 1

- NOTES: UNLESS OTHERWISE SPECIFIED
- ALL DIMENSIONS ARE IN MILLIMETERS (mm) AND VALUES ARE IN SI UNITS. DIMENSIONS AND VALUES IN BRACKETS ARE U.S. CUSTOMARY UNITS (inch)
 - APPLICABLE STANDARDS AND SPECIFICATIONS: ASME Y14.5M-2009, DIMENSIONING AND TOLERANCING
 - REMOVE ALL BURRS AND BREAK EDGES 0.25 [.010] TO 0.75 [.030] CHAMFER OR RADIUS.
 - FORGED MATERIAL SHALL CONFORM TO THE FOLLOWING: NITRONIC 50, SOLUTION ANNEALED. ULTRASONIC INSPECTION CONFORMING TO ASTM-A388 SHALL BE PERFORMED.
 - PERMANENTLY MARK PART WITH DRAWING NUMBER, REVISION LETTER, AND PART SERIAL NUMBER IF APPLICABLE, APPROXIMATELY WHERE SHOWN IN 6 [.25] HIGH CHARACTERS. MARKING PROCESS TO BE APPROVED BY LBNL PRIOR TO MARKING PART.

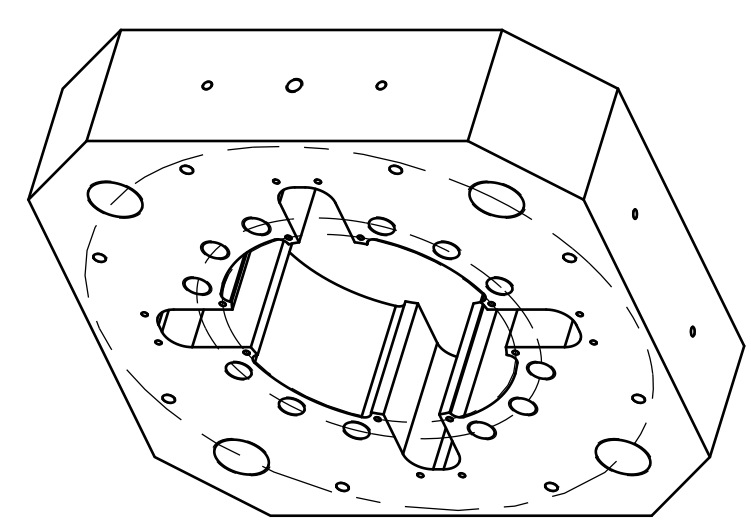

ISOMETRIC VIEW
FOR REFERENCE ONLY
SCALE 0.250

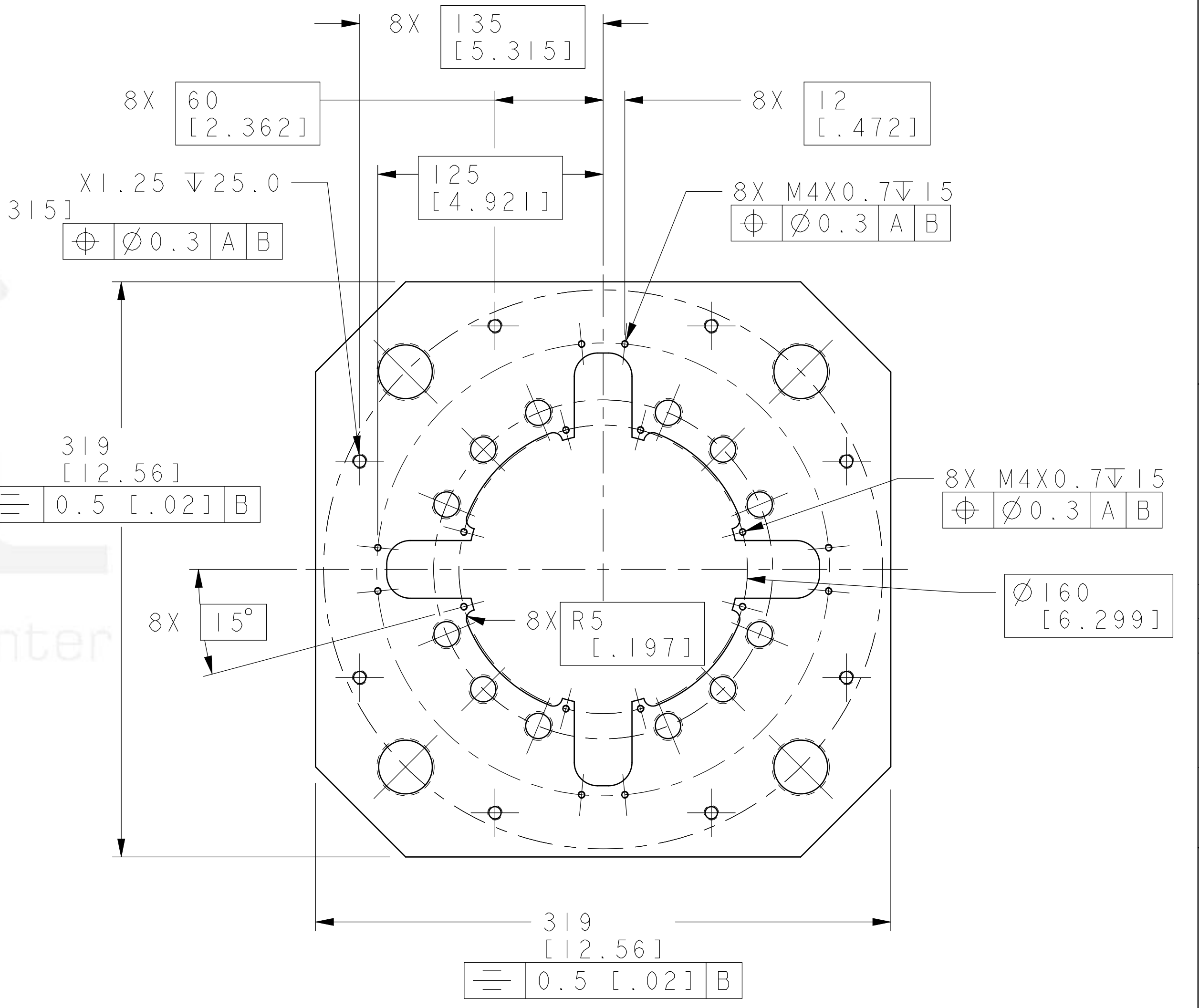
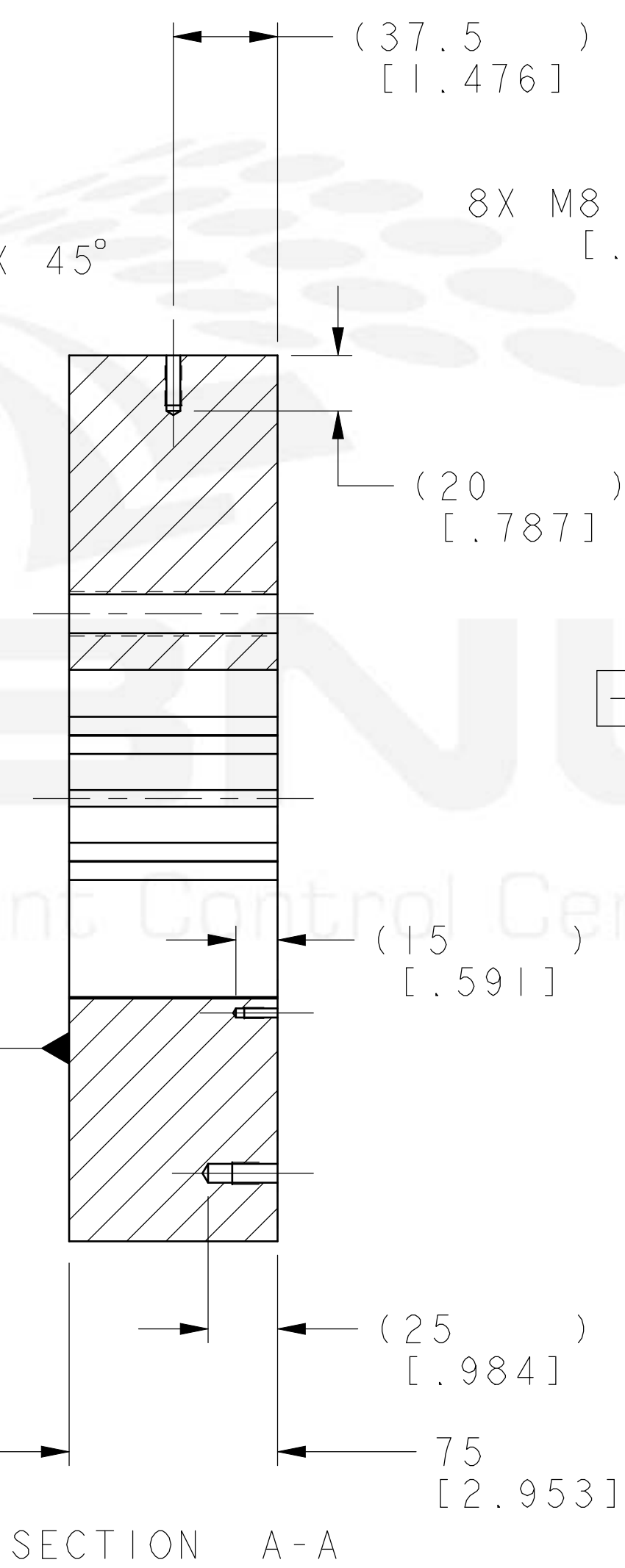
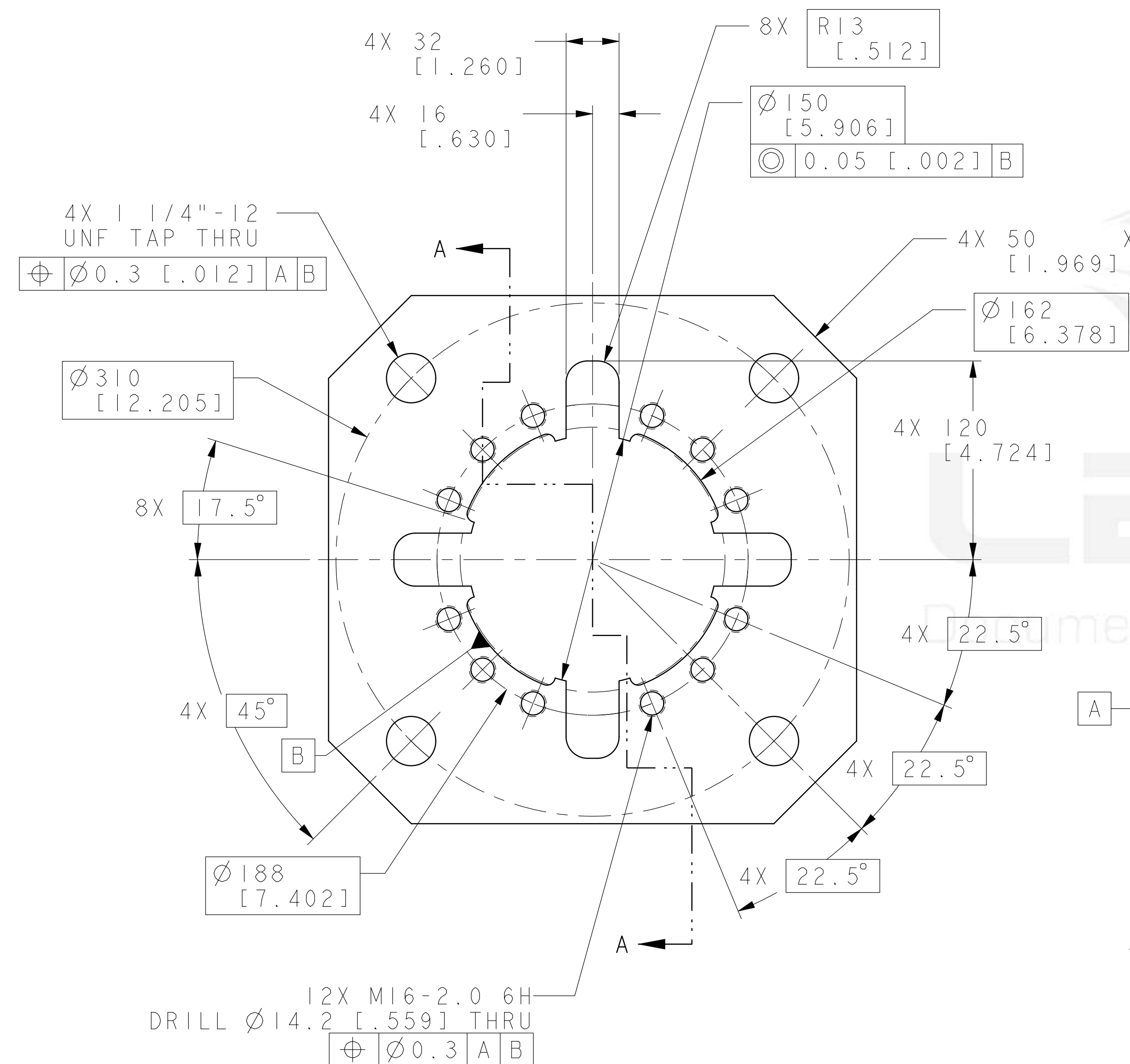
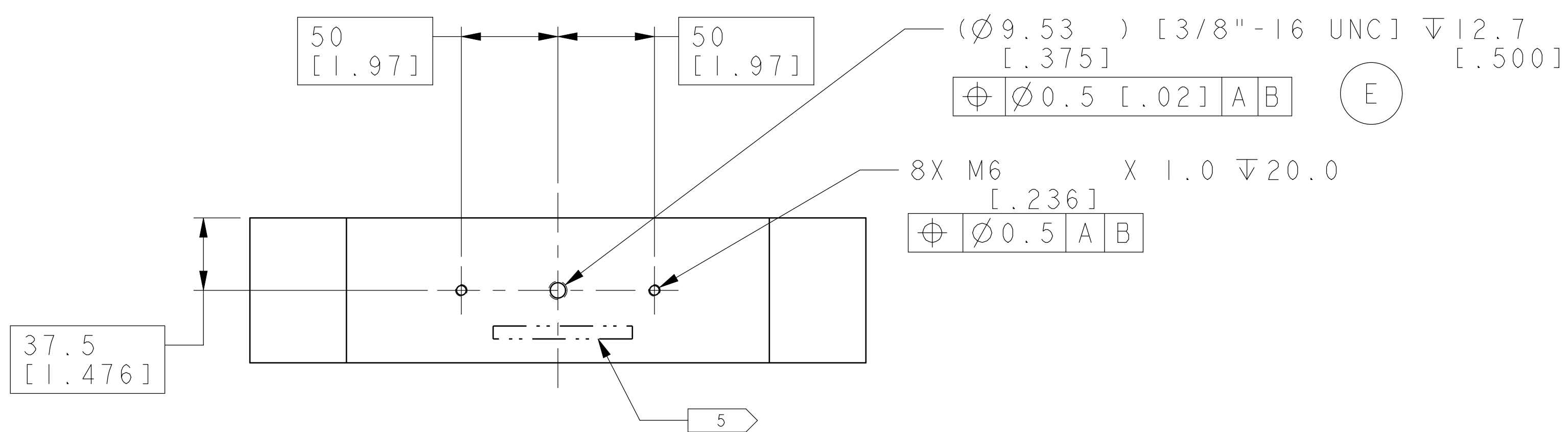

DWG. NO. 27K557 REV. SH. E 1

SEE LBNL P1M FOR REV. HISTORY	REV (STATE): E.2 (Released)	UNLESS OTHERWISE SPECIFIED	PROJECT NAME: SUPERCONDUCTING MAGNET PROGRAM	ERNEST ORLANDO LAWRENCE BERKELEY NATIONAL LABORATORY UNIVERSITY OF CALIFORNIA	
	AUTHOR: Wirdzek, John	TOLERANCES X±1, .X±.5, .XX±.25	UNIQUE NUMBER: SU-1004-2019		LARP QXF LOXF MAGNETS QXF LEAD END AXIAL PLATE
	CHECKED BY: DWCHENG	FRACTIONS: ± -/..	DO NOT SCALE PRINT	CATEGORY CODE: SU3323	
	CHECKED AT: Jun 20 2019 11:32:55 PM PDT	ANGLES: ± 1°	SCALE: 0.500	1 SHEET OF 1	SIZE: D
	RELEASED BY: DWCHENG	MACH. SURFS.: 125 ✓ OR BETTER	THIRD ANGLE PROJECTION	DWG NO: 27K557	REV: E
RELEASED AT: Aug 23 2019 9:24:51 AM PDT	REF: ASME Y14.5M-2009, THREADS ARE CLASS 2				
CHG DESCR: CHANGE: ADDED 3/8"-16 UNC HOLE; ADDED NOTE 5	BREAK EDGES .016 MAX, ON MACHINED WORK REMOVE BURRS, WELD SPLATTER & LOOSE SCALE				

8 7 6 5 4 3 2 1