

Magnetized Iron Neutrino Detector (MIND)

Re-Optimize for lower energy

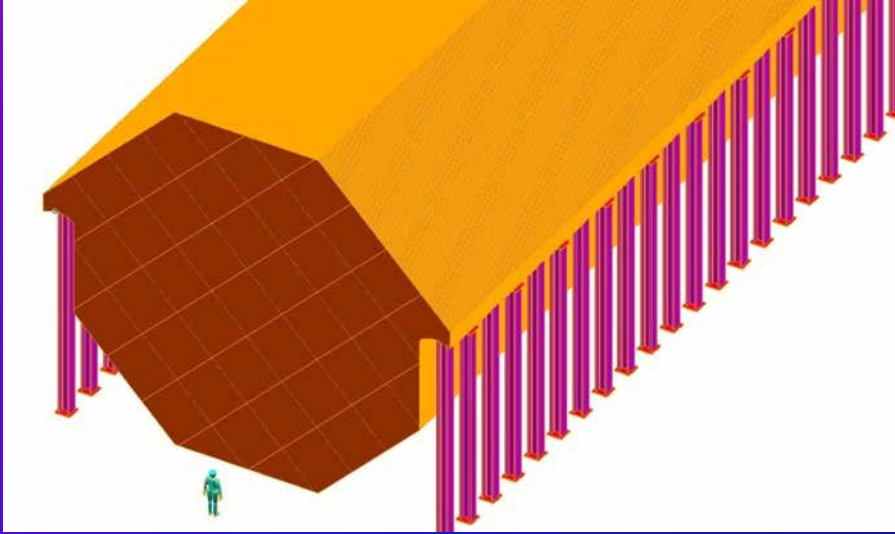

- ∅ MIND was optimized for the "Golden" channel at the NF (25 GeV mstorage ring)
- ∅ Optimization for FD for $L/E \gg 1$
 - ∅ Essentially Minos ND with upgrades
 - ∅ Reduce plate thickness (1 cm)
 - ∅ 250 kA-turn excitation (SCTL)
 - ∅ XY readout between planes

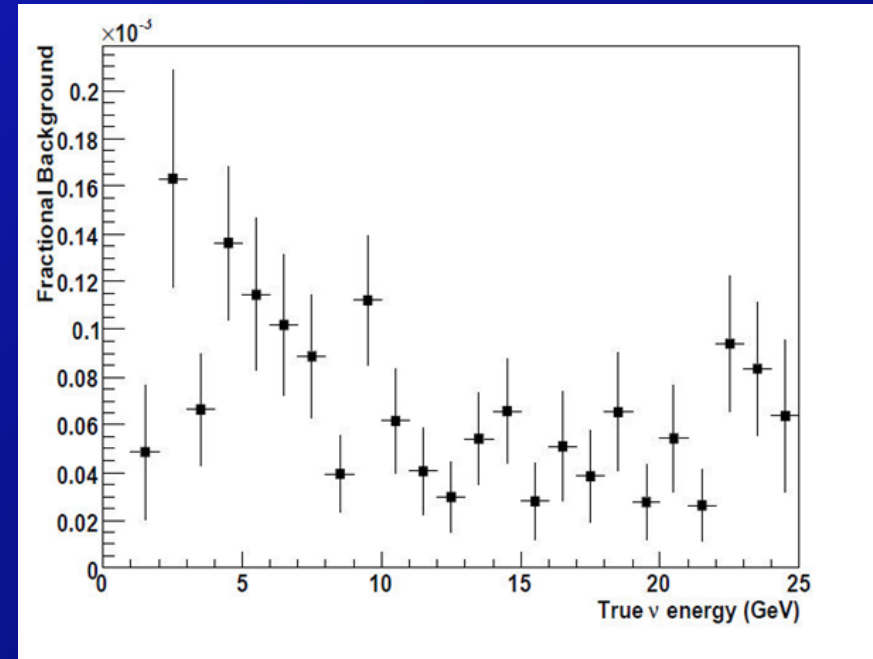

Super B Iron Neutrino Detector *SuperBINd*

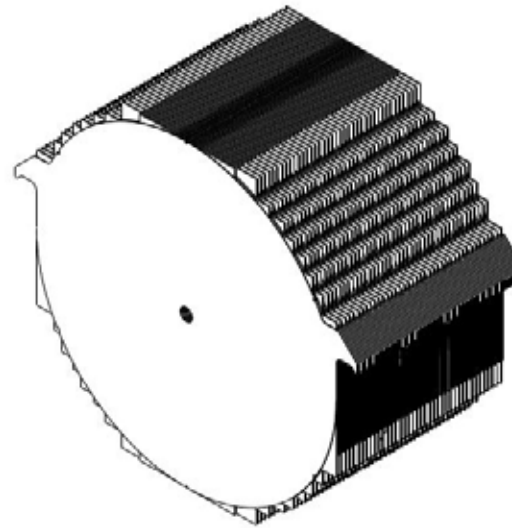
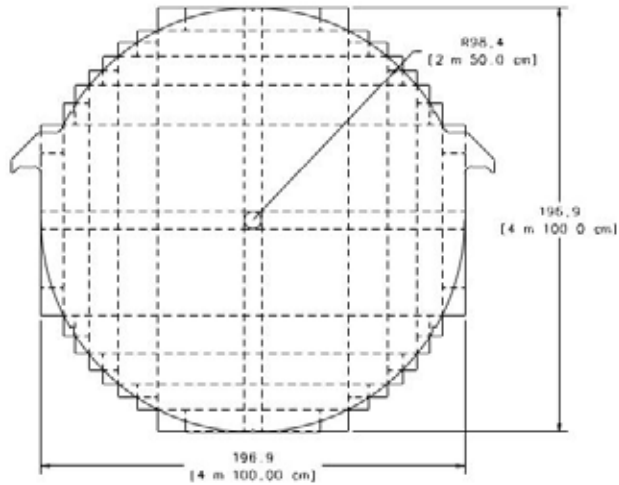

- Ø 1 cm plate
- Ø 5 m diameter
- Ø 20 cm hole for SCTL

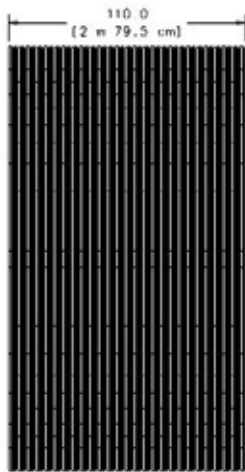

UNLESS OTHERWISE SPECIFIED		ORIGINATOR
1	VIEW ALL SHARP EDGES	ORIGINATOR
2	30 NOT SCALE DRAWING	ORIGINATOR
3	USE ALL DIM. SURFACES	ORIGINATOR
4	USE ALL DIM. SURFACES	ORIGINATOR
5	SHARP EDGES	ORIGINATOR
APPROVED		APPROVED
USED ON		USED ON
MATERIAL		MATERIAL
FERMI NATIONAL ACCELERATOR UNITED STATES DEPARTMENT OF		
SCALE	DRAWING NUMBER	

B Field Simulation

