

Megacell testing setup at CERN

A. Cervera
(IFIC-Valencia)

LAr test area at EHN1

- Discussions of Flavio with NP director were positive regarding a testing area with LAr at EHN1
- We will get a well delimited area just outside the PDS room
- We will need work out the details with Filippo.
 - Safety issues and permits
 - LAr delivery
- He will take care of this but needs email with details

The dewar at building 182

- The dewar has inner dimensions: 70-71 cm diameter and 1220-121 cm height
- It has been used regularly, so it should have no leaks
- Needs to be cleaned and transported to ENH1
- Francesco is the contact person for that



Top lid design

Jesus Álvarez (IFIC)

- With polystyrene panels below
- Need a FT for temperature sensors
- Need FT for cryogenic pump

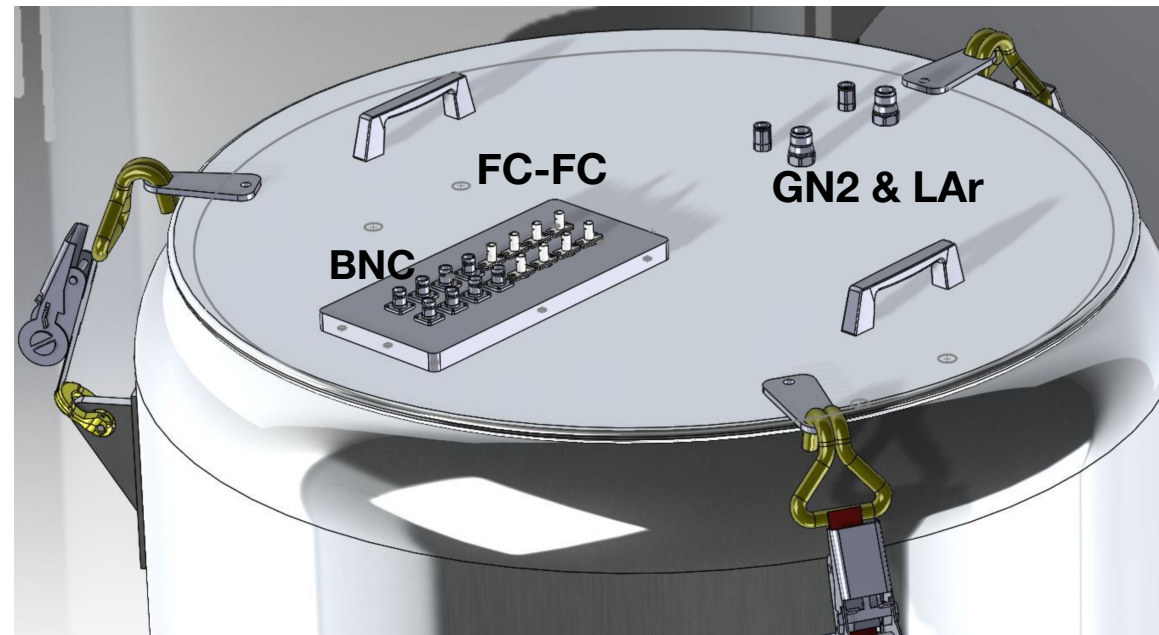
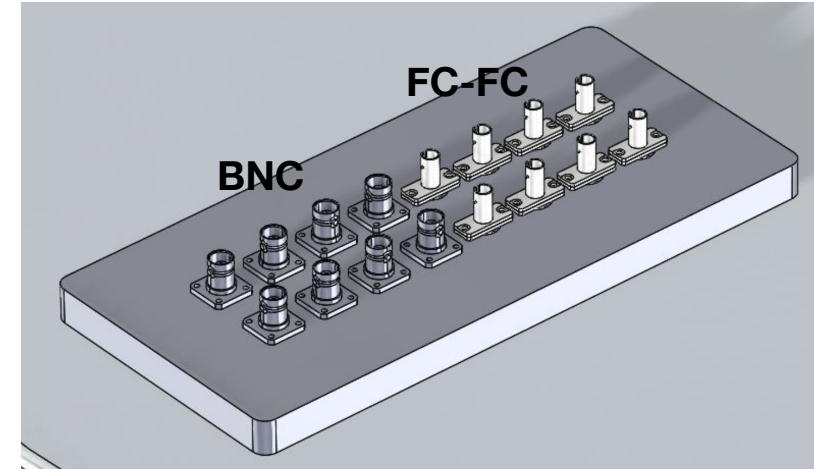
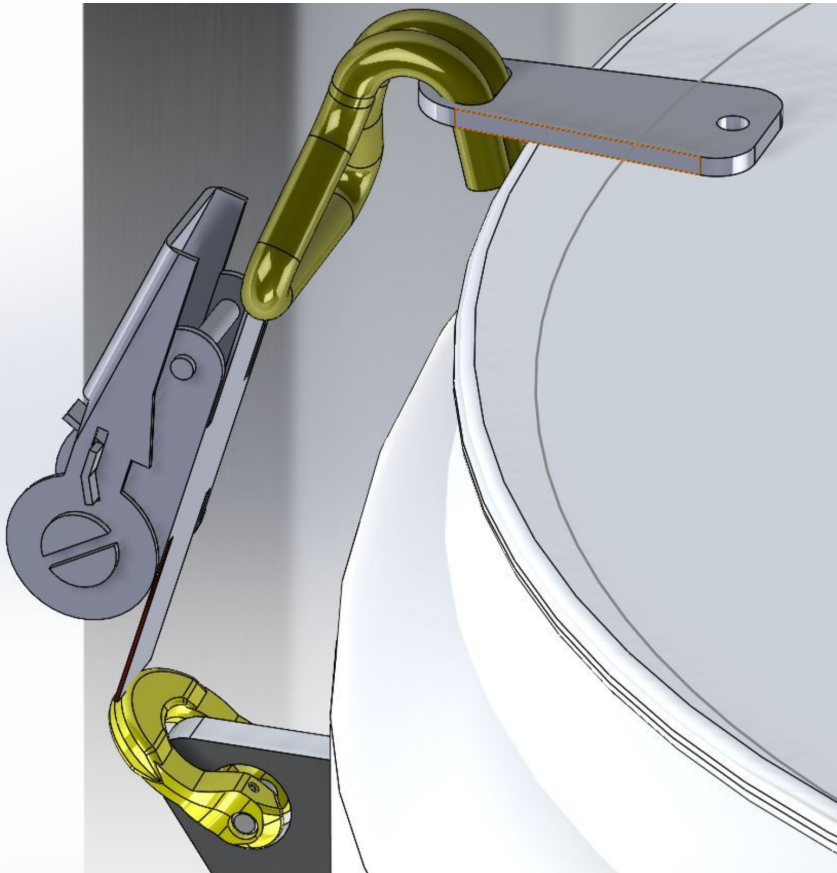

Cryogenic pump

- Pump available at 182
- 118 cm height
- 4 cm diameter tube

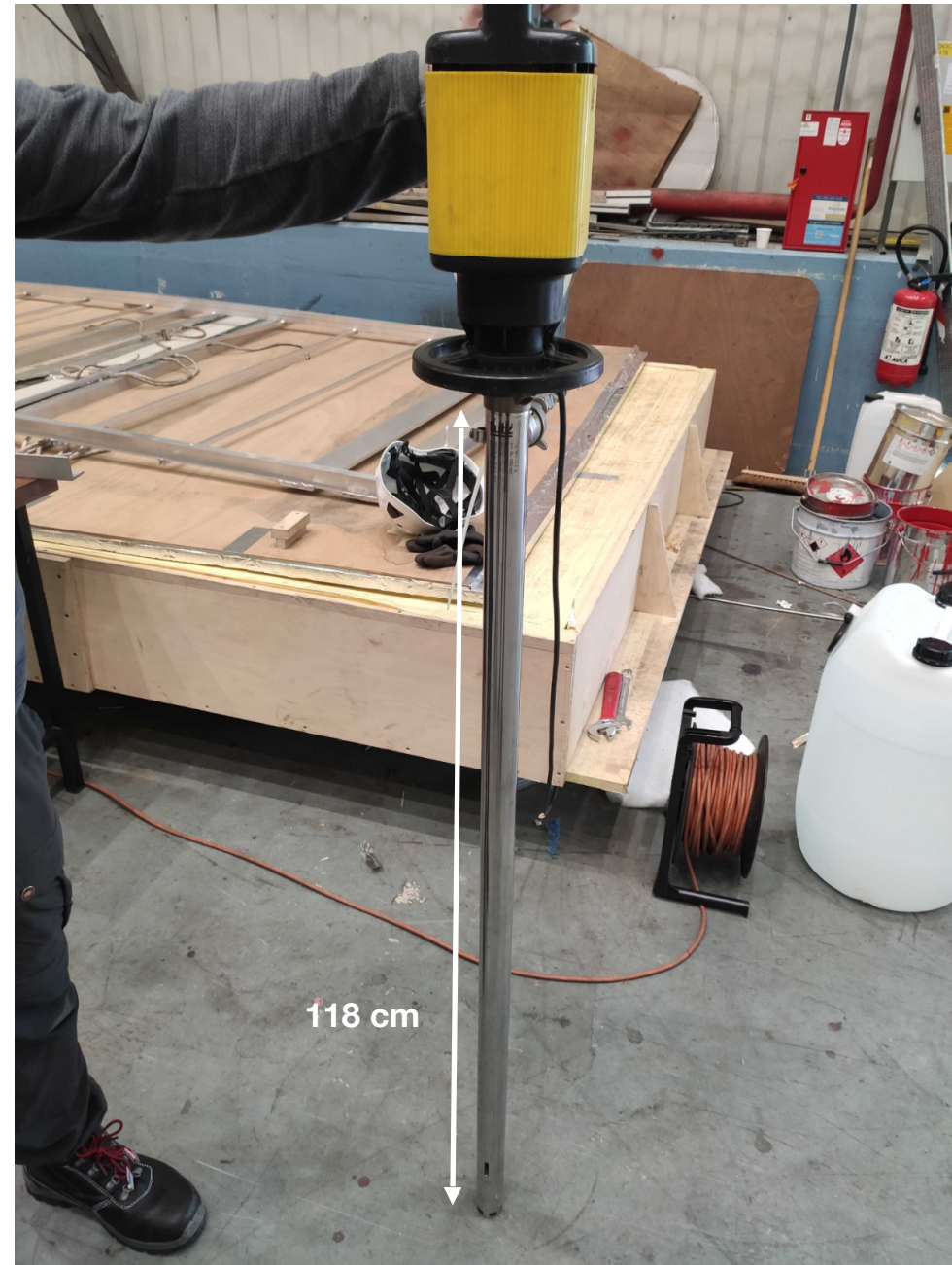

Support for arapuca

- Support for x-arapuca (blue). To be designed by module designers

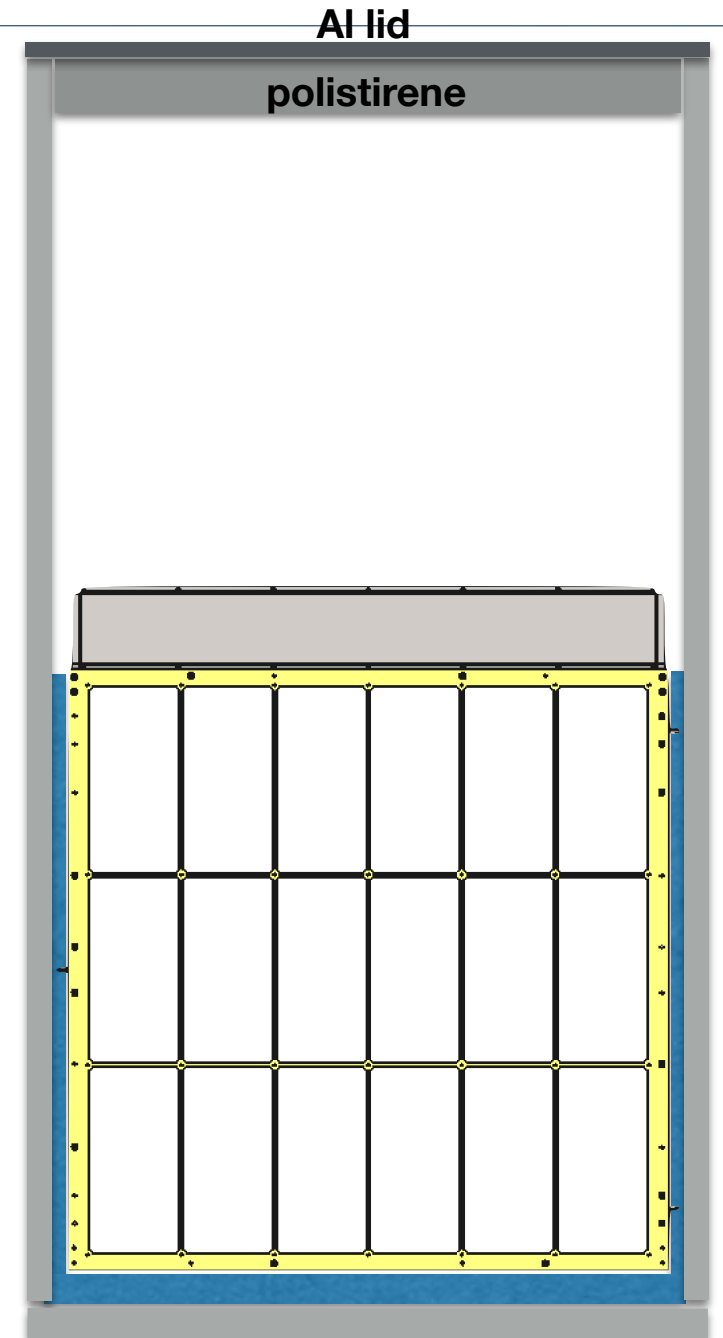

Operation modes

- System with polystyrene volume to reduce LAr usage and allow XA outside LAr

top view

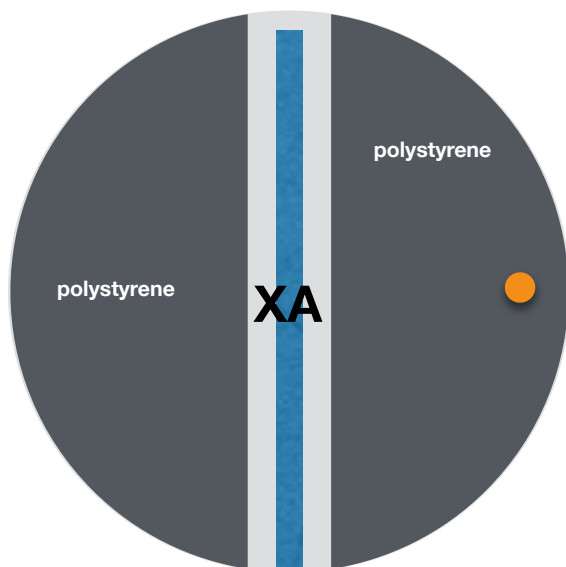

side view

