

Cold Box Membrane Mount Assembly

Jay Jablonski

November 17, 2023



Support Frame CAD Model

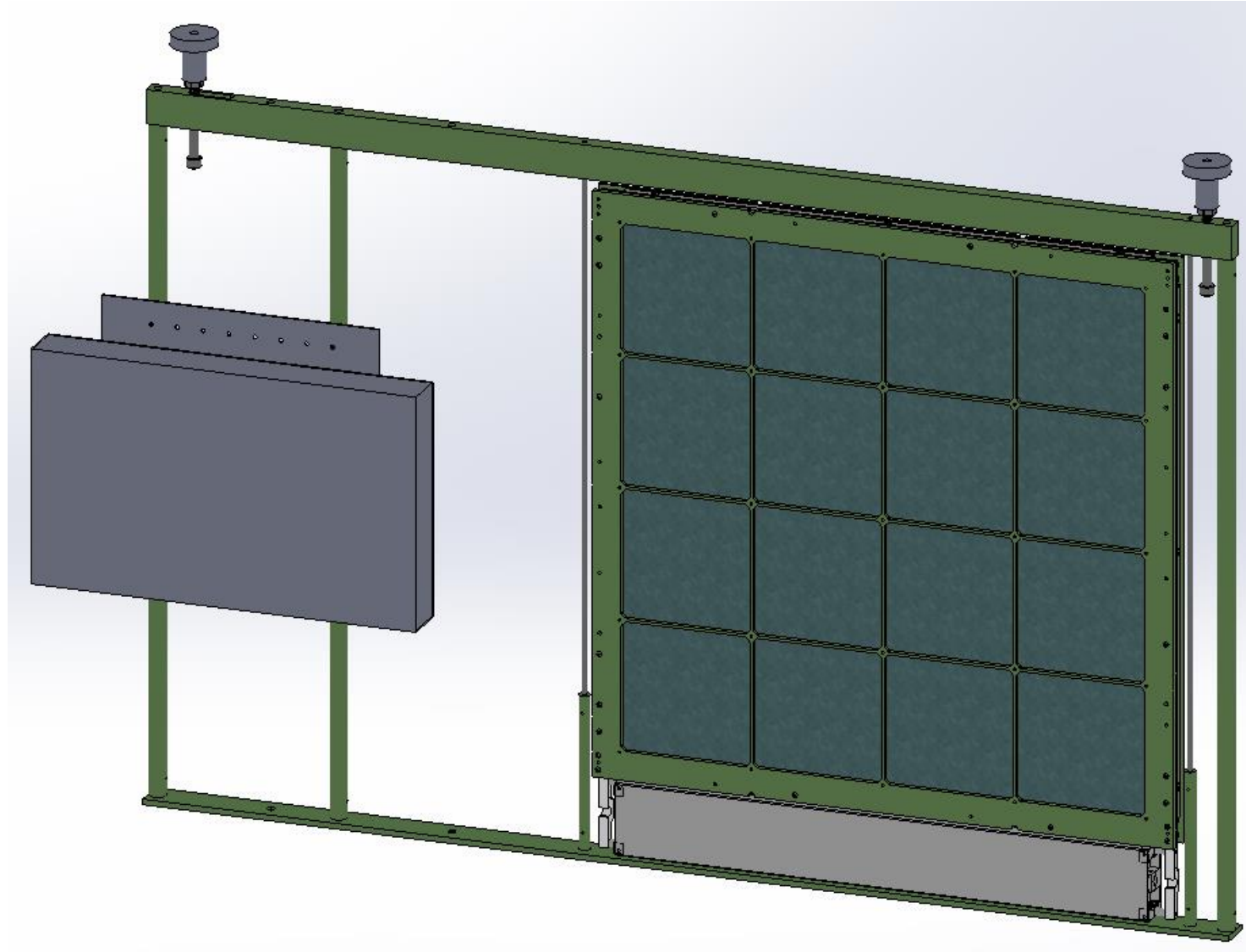

Support Frame-Components

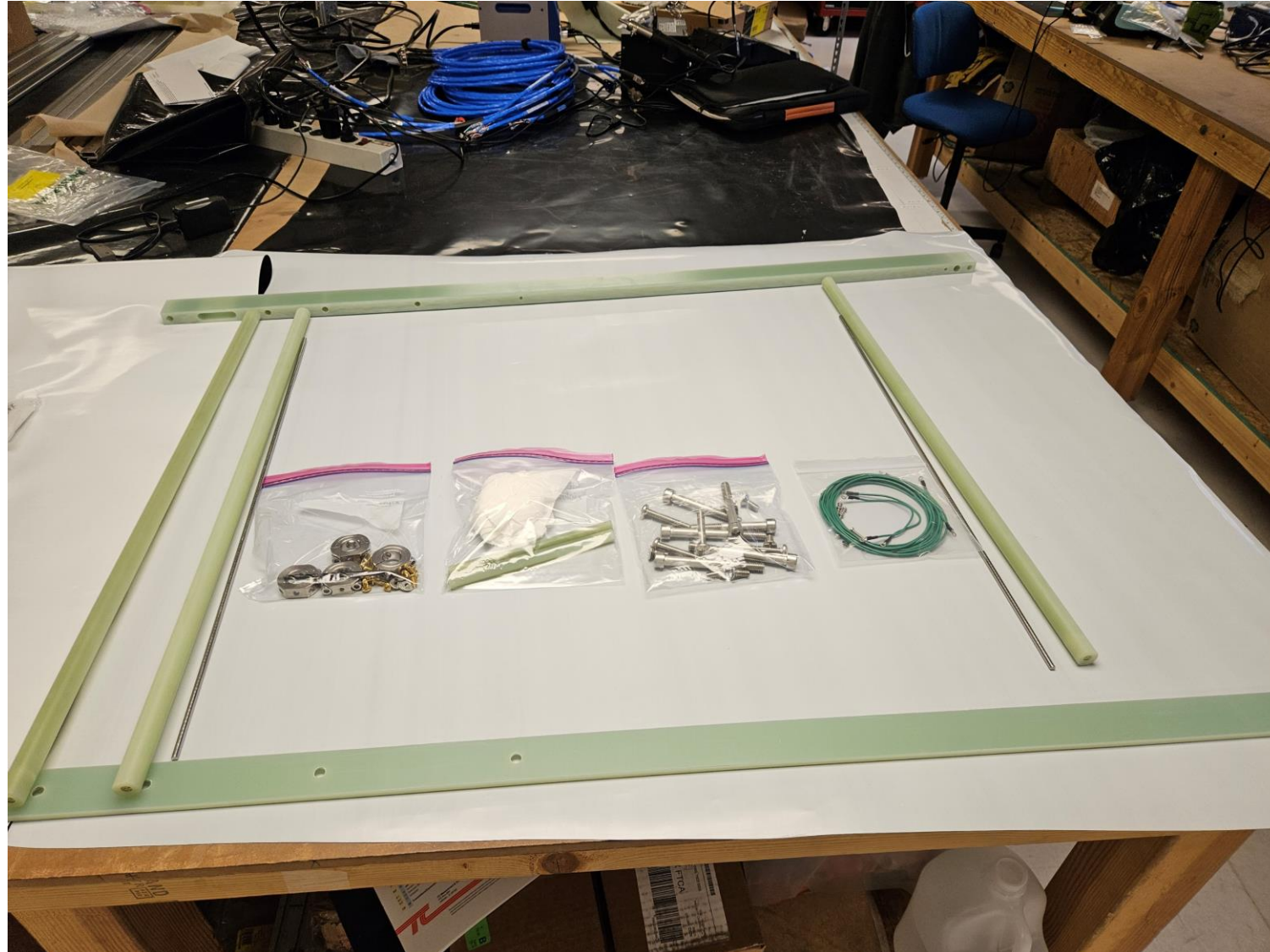

Install 3 x long Rods to bottom plate

- 3 x 5/16-18 x 3/4" Phillips Flat Head Screw



Confirm Fiber Box hole spacing

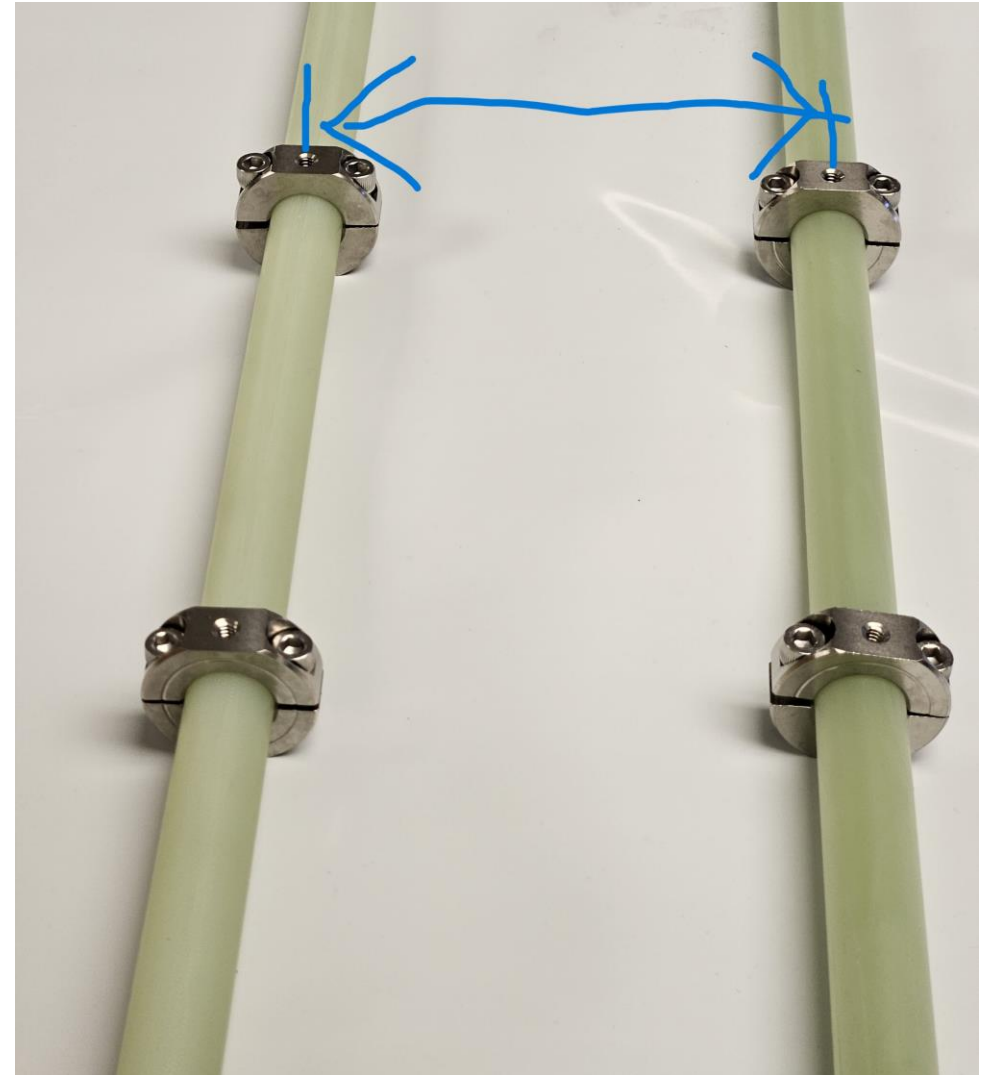
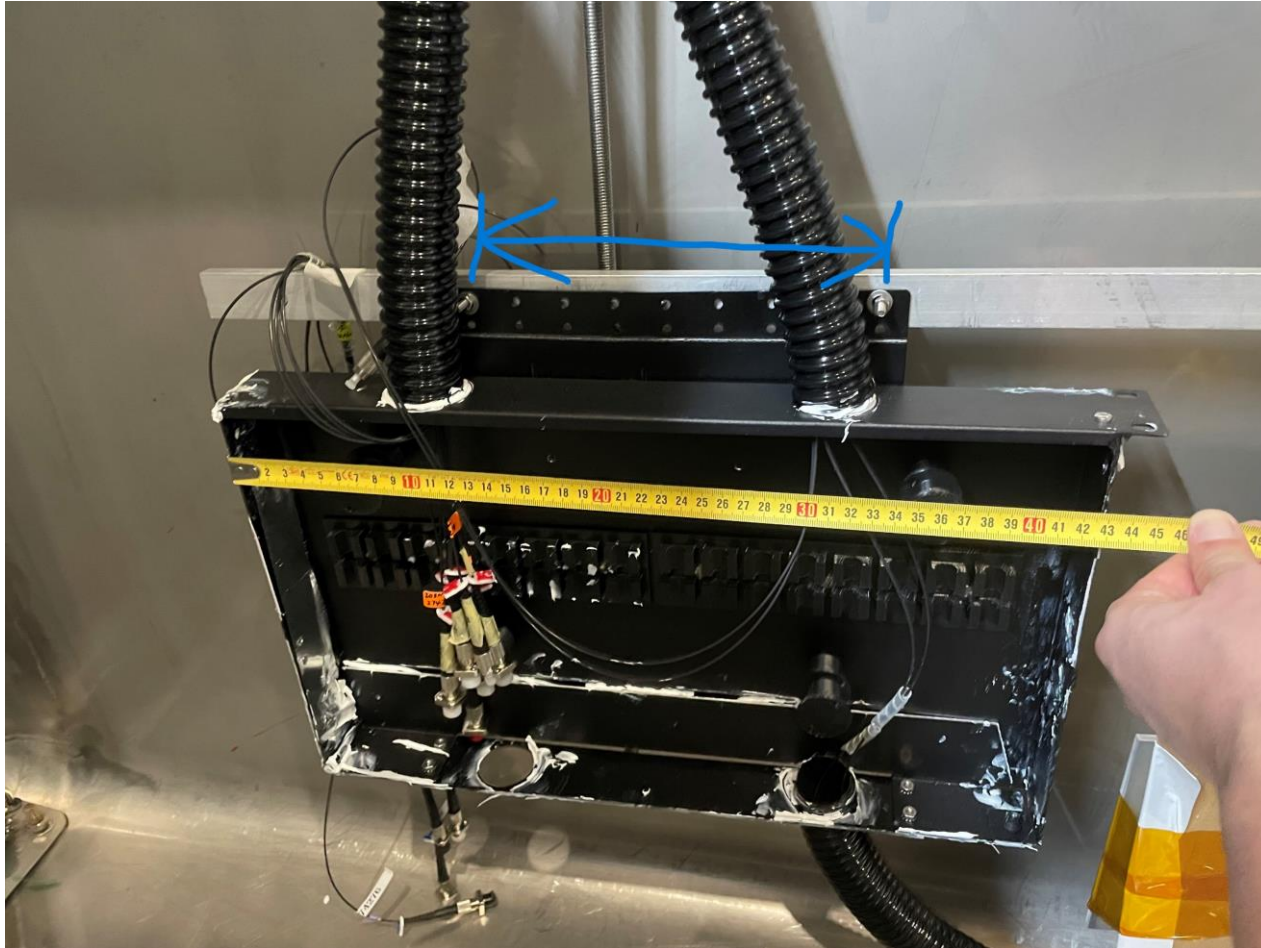

Rods can be installed in multiple locations

- Fiber enclosure mount holes will determine location of the two rods on the left side

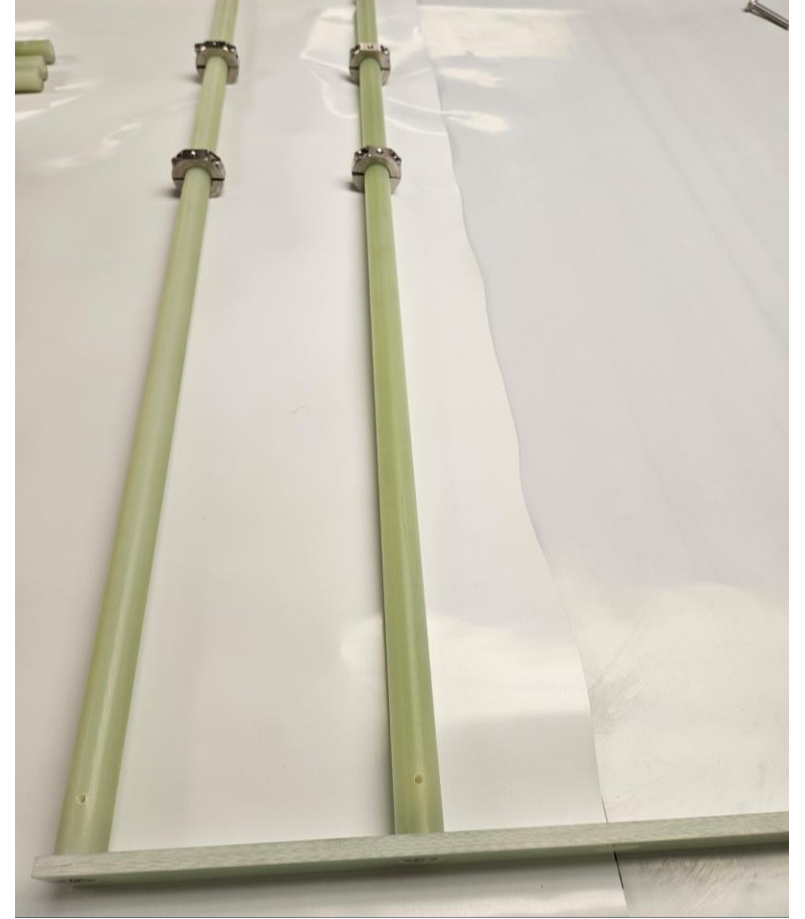
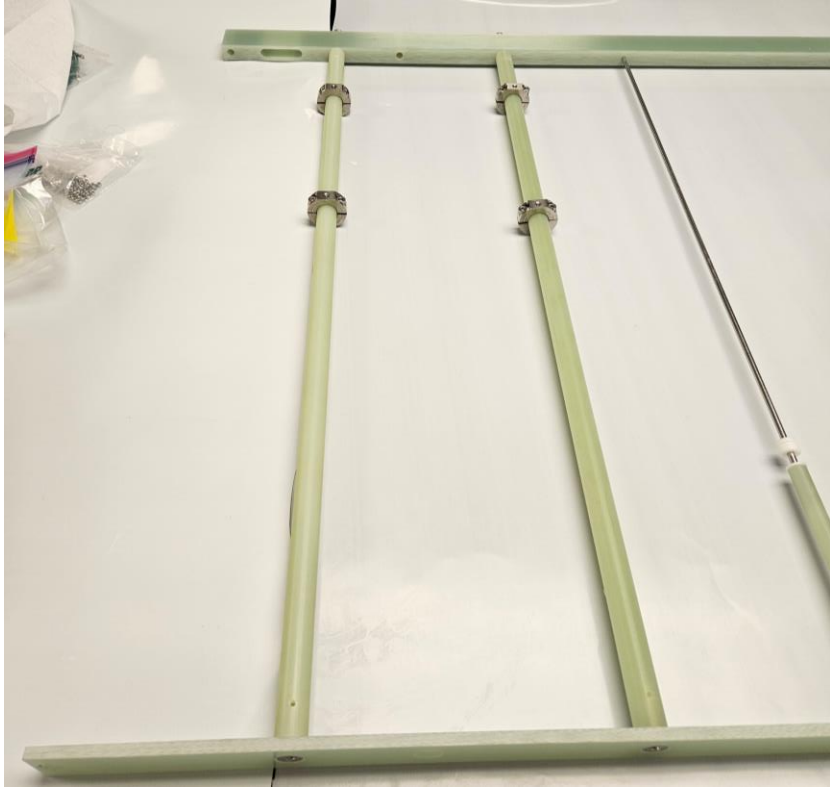

Install 2 x Short Rods to bottom plate

- 2 x 5/16-18 x 3/4" Phillips Flat Head Screw

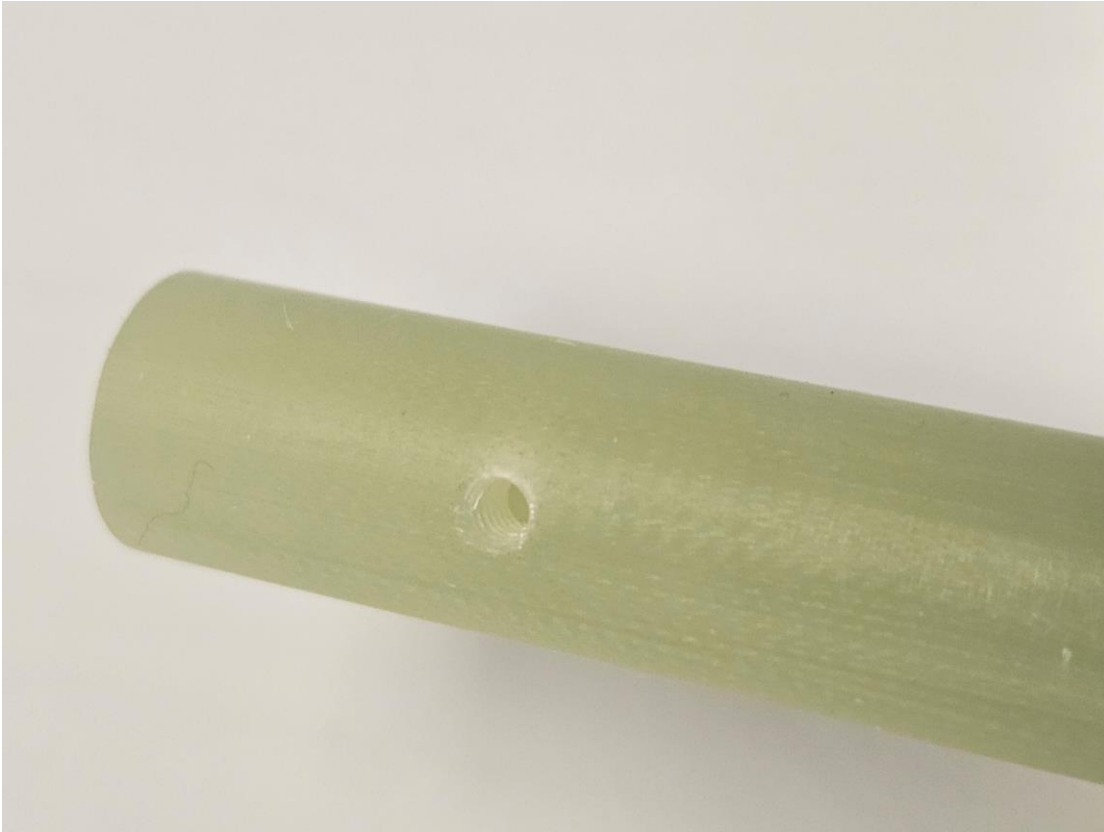

****M3 Tapped hole faces into the table****

Install Top Bar

- 3 x 5/16-18 x 2" Phillips Pan Head Screw



Install 5mm rods



Add 5mm Washers

- Add enough washers such that the electronics box is not touching the bottom plate of the frame (~3mm gap)
- Washers should replace u-Clamp

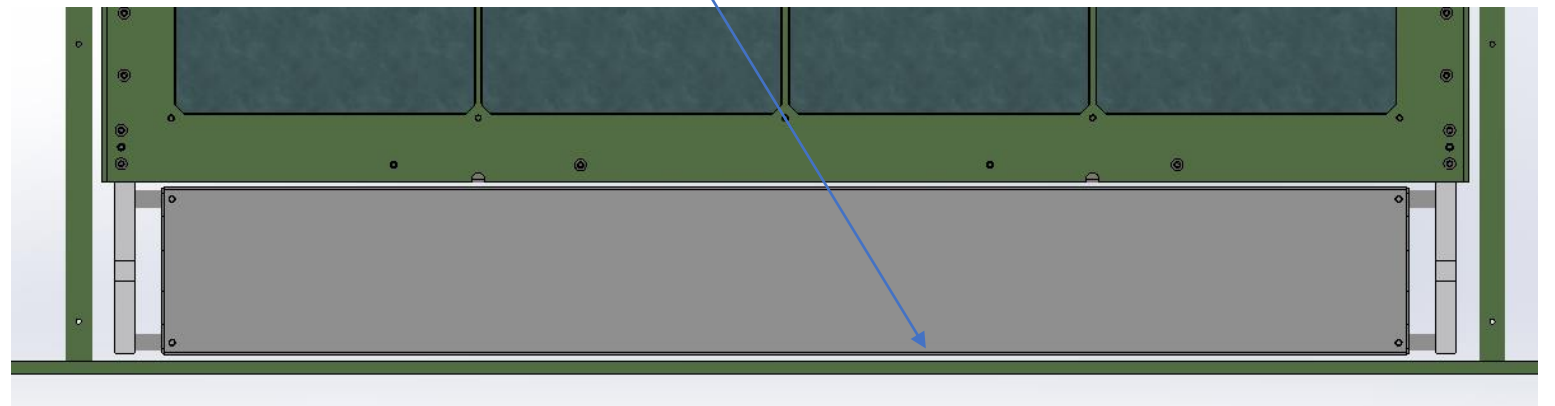
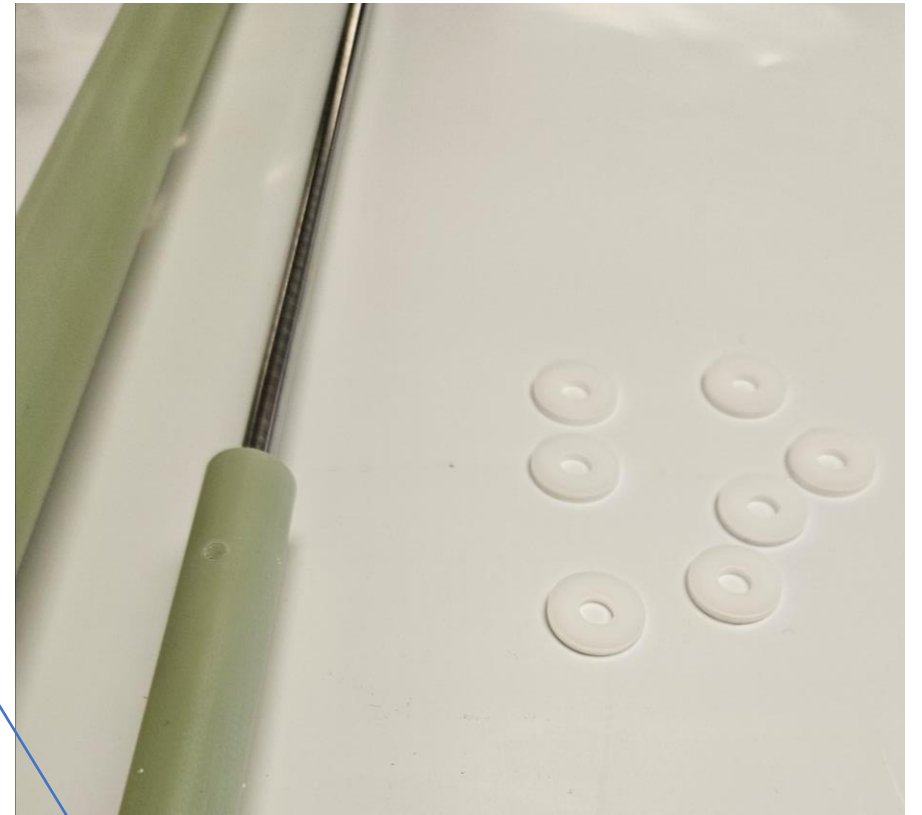
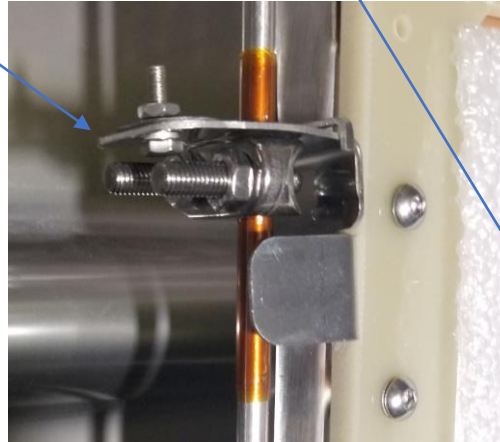

Support Frame-Assembled



Install Rod ground wires

- 2 lengths are provided to choose from

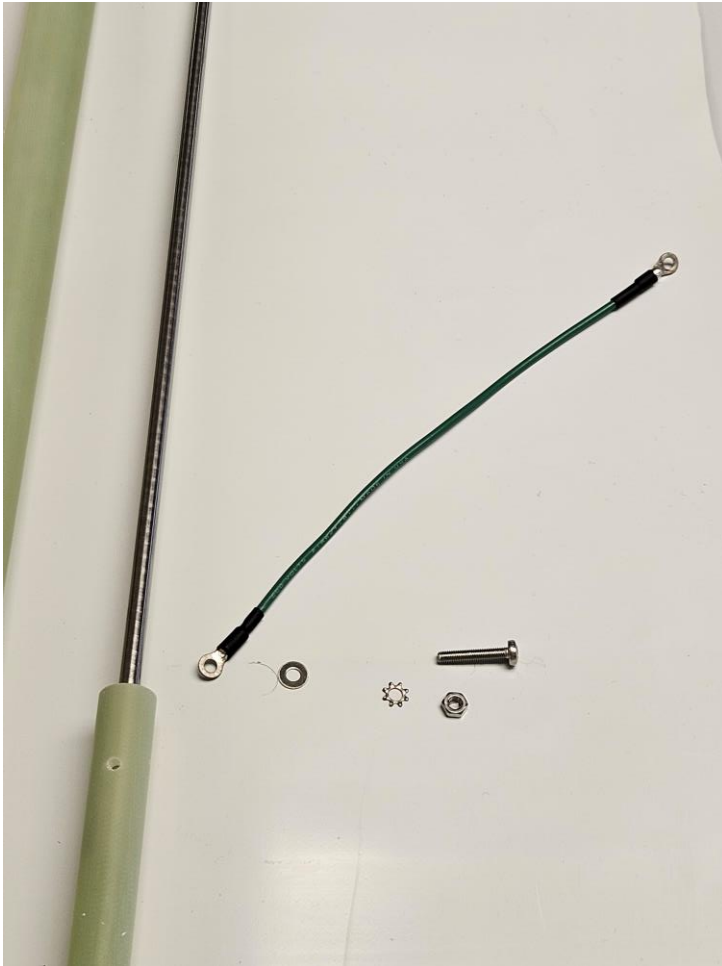

Install Rod ground wires

- Flip module over so 3mm holes in short rods are facing up



Install Rod ground wires

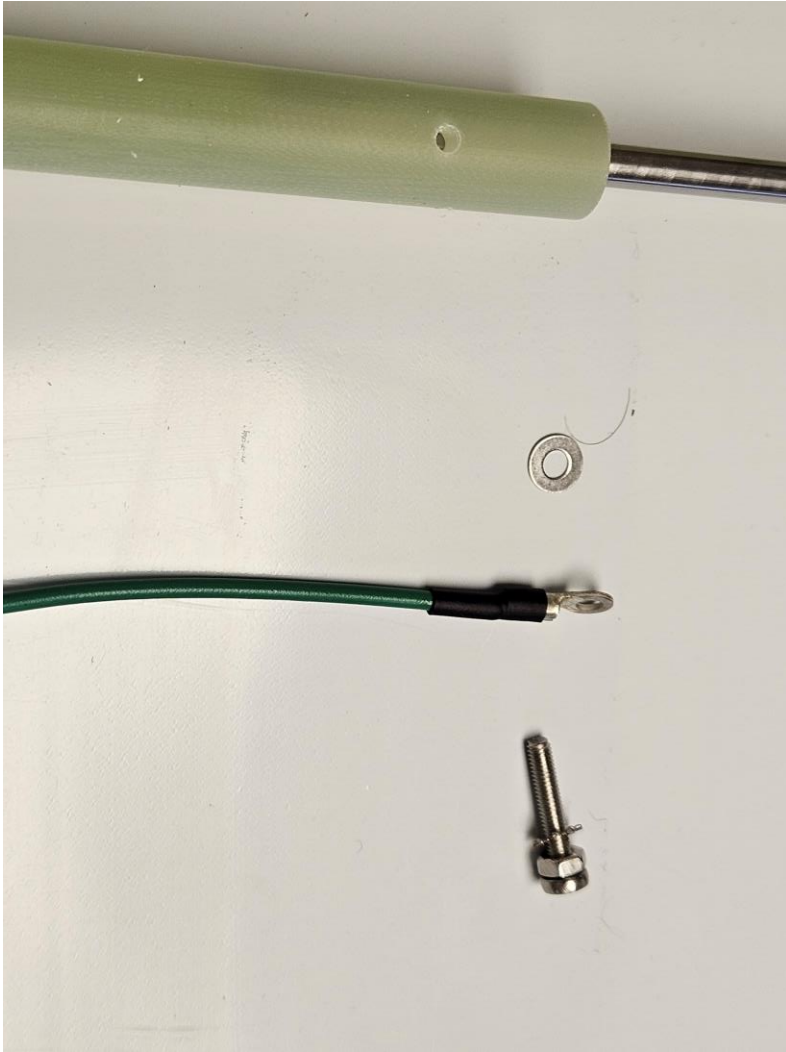

Order of Fasteners

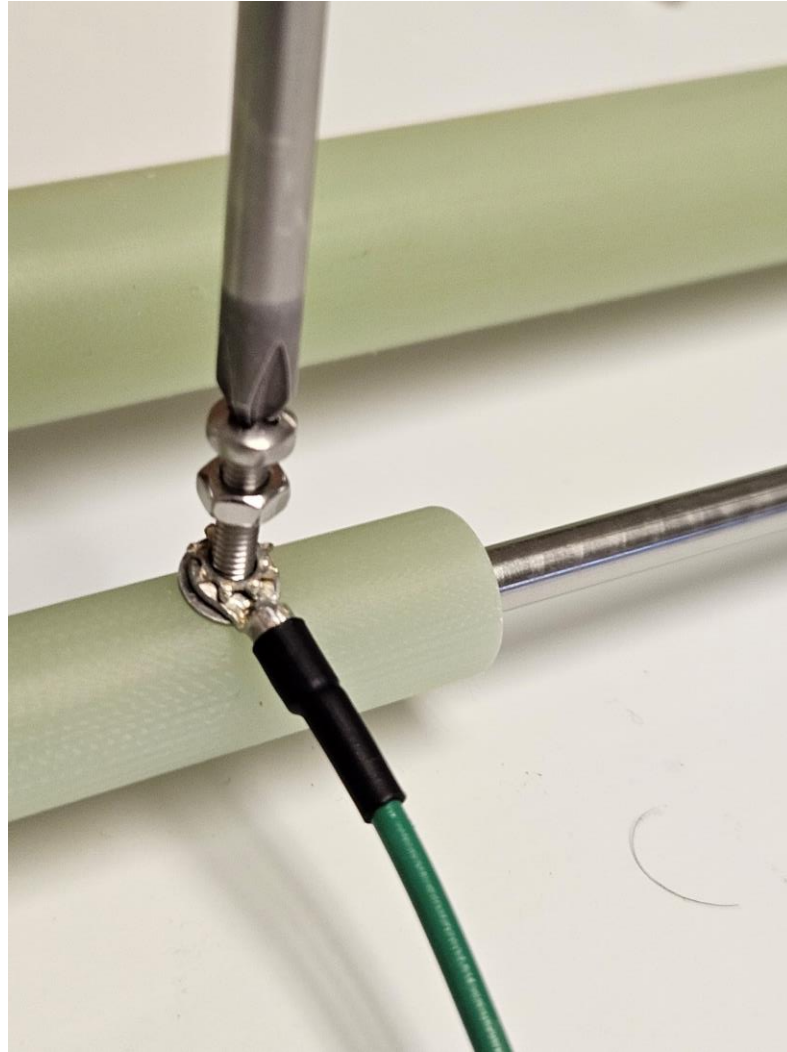

Tighten screw first

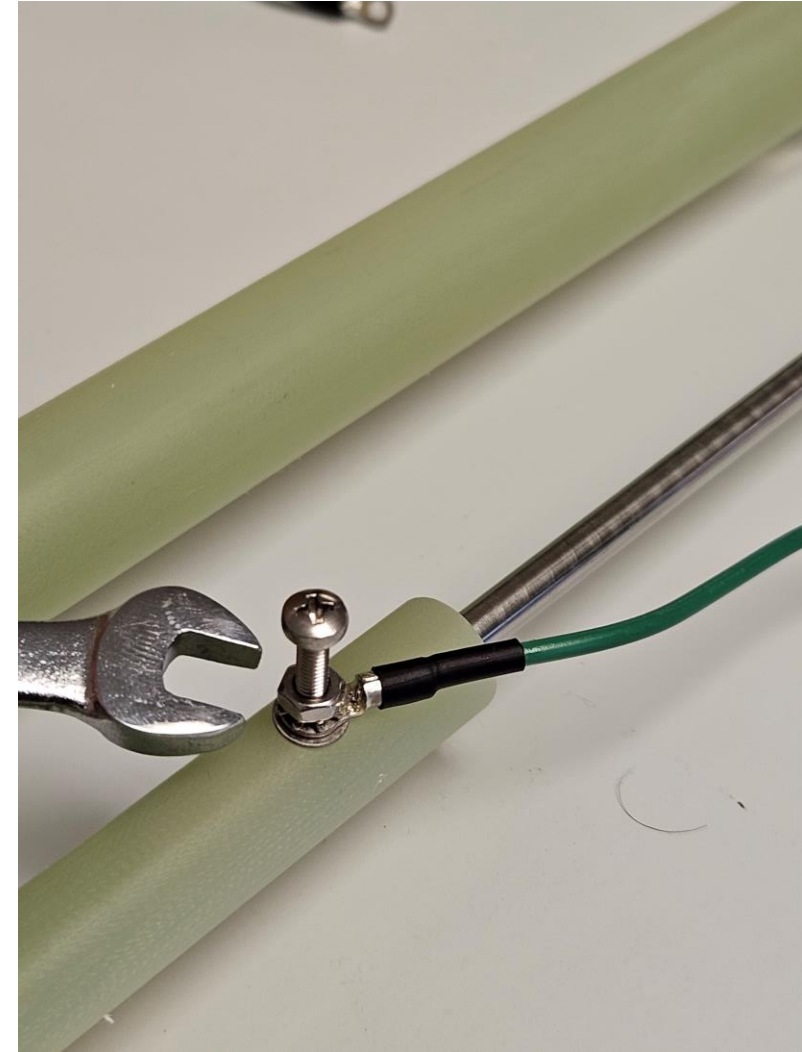

Tighten 3mm nut

Mount Fiber Enclosure

- Confirm Clear holes in enclosure are large enough for the supplied screws
- Drill bit is included if holes need to be enlarged

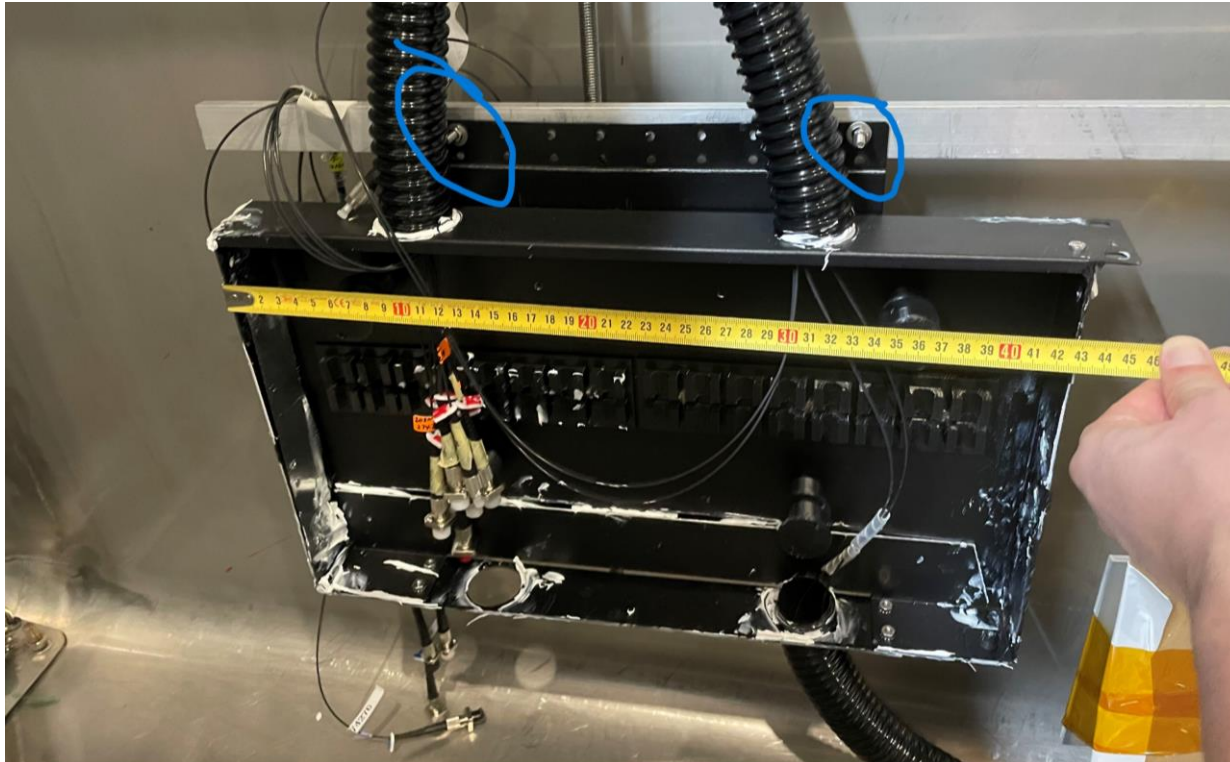

Mount Fiber Enclosure

- Mount Box using 2 x 10-24 Brass Pan Head Screws & washers
- Bottom Clamps are just for spacing the box off the frame



Mount Frame in Cold Box

- Mounts may need to be relocated to align with the hole/slot in the frame
- Use 2 x M10 SHCS to install frame to existing mounts in the Cold Box
- Use existing nuts to Jam the screws in place

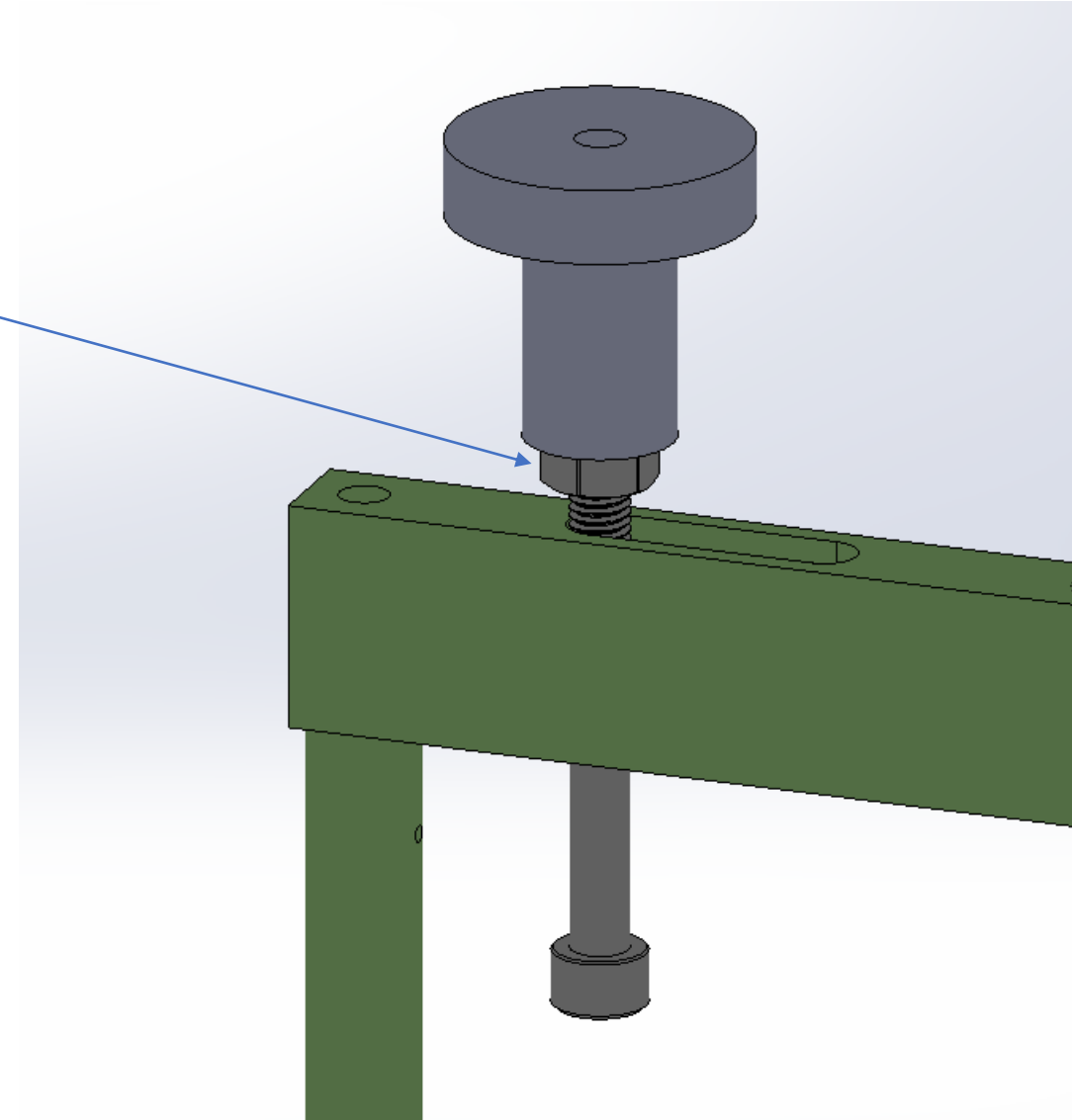
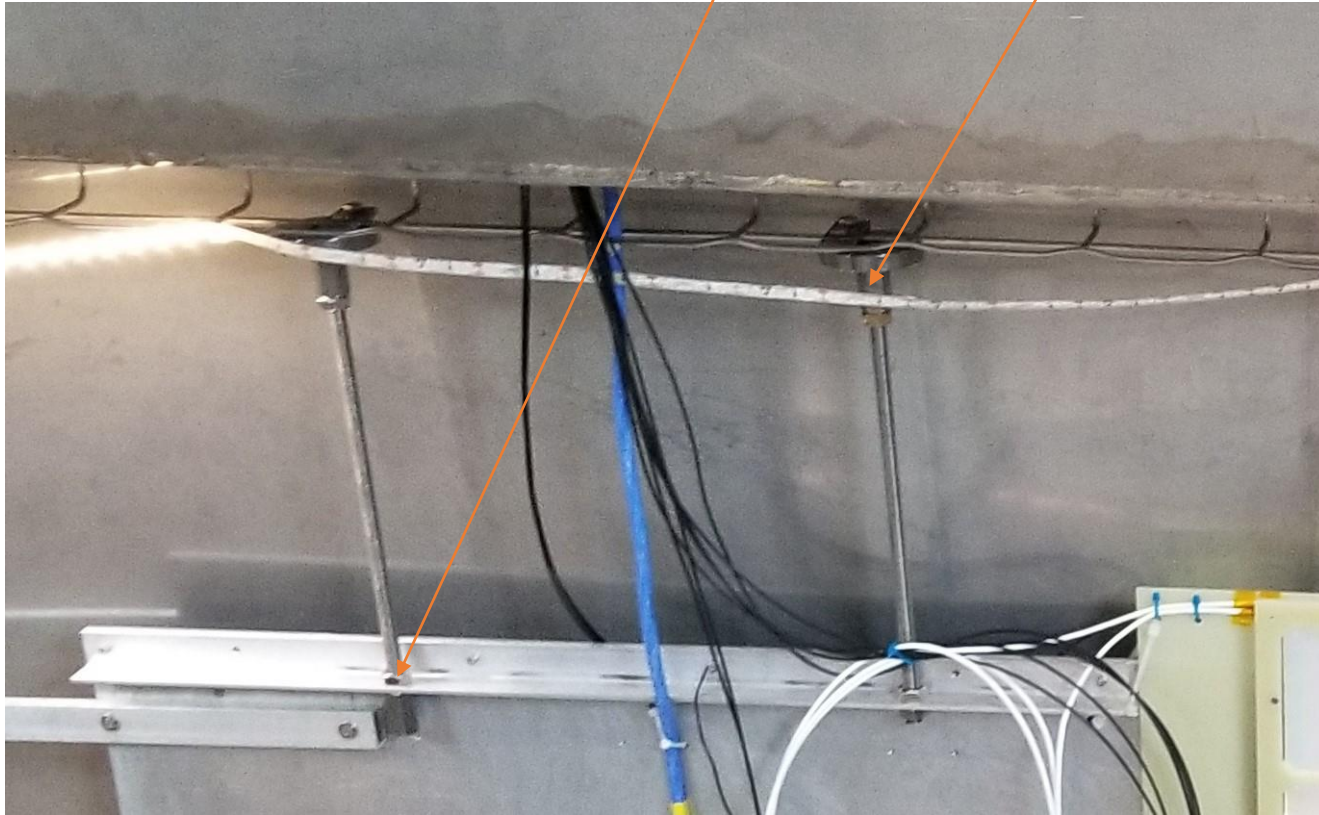

Mount Frame in Cold Box

- The frame should sit on the Cold Box floor and no weight should be hanging off the Cable Tray
- Screws just prevent frame from tipping over

