

MPPC to WLS fiber Connector

Thomas Kutter, LSU

MPPC to WLS Fiber Interface

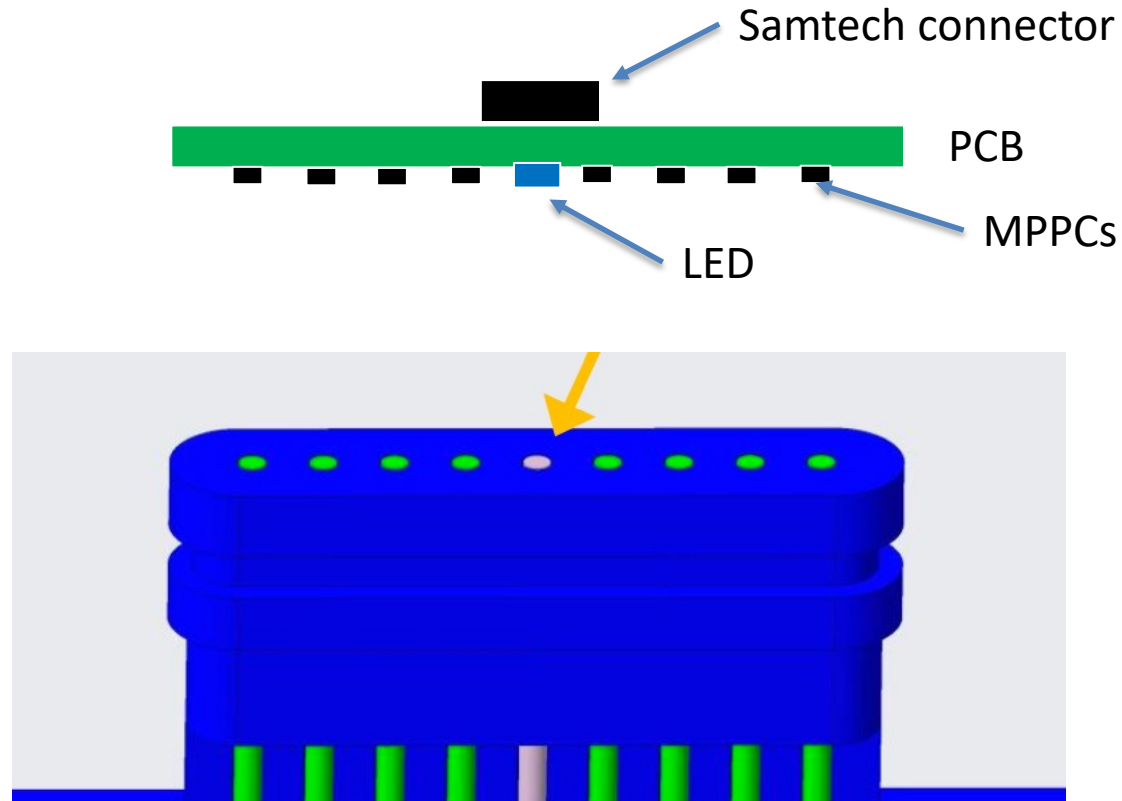

Flat MPPC to WLS Fiber Interface

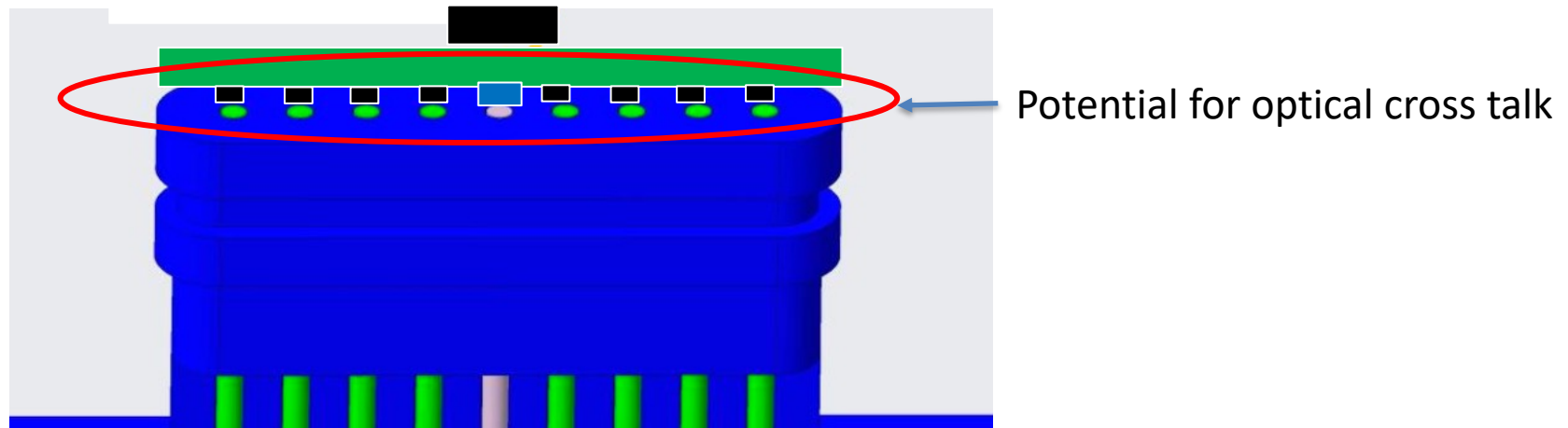

- Height mismatch between MPPC and LED likely
→ leads to poor coupling between MPPCs and WLS-fiber
- Potential for direct light injection from LED into MPPC
→ bypassing crucial check of fiber to MPPC interface

MPPC to WLS Fiber Interface

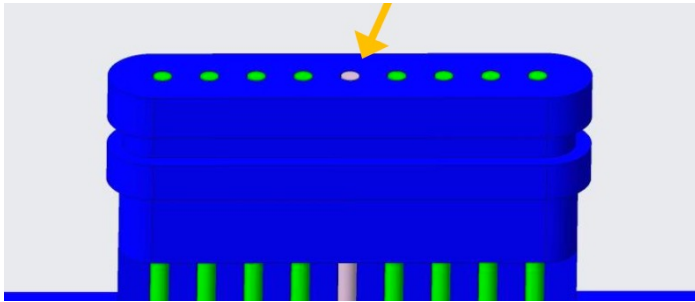

Polishing of clear fiber for LED light not so critical
→ Can accommodate LED height difference

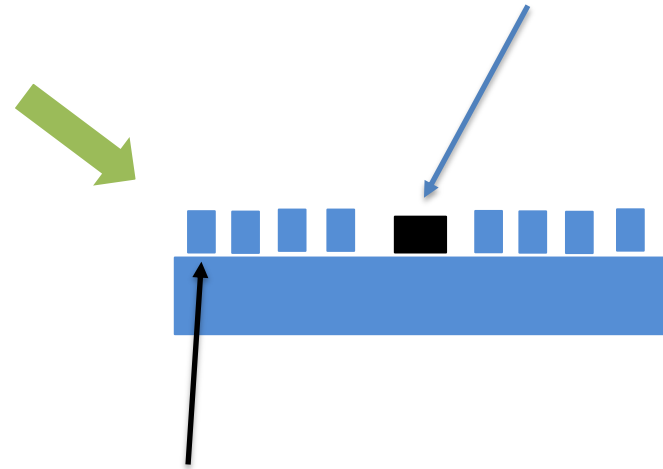

Individual ferrule stubs allow to eliminate/reduce optical cross talk

Modified MPPC to WLS Fiber Interface



Individual ferrule stubs allow to eliminate/reduce optical cross talk

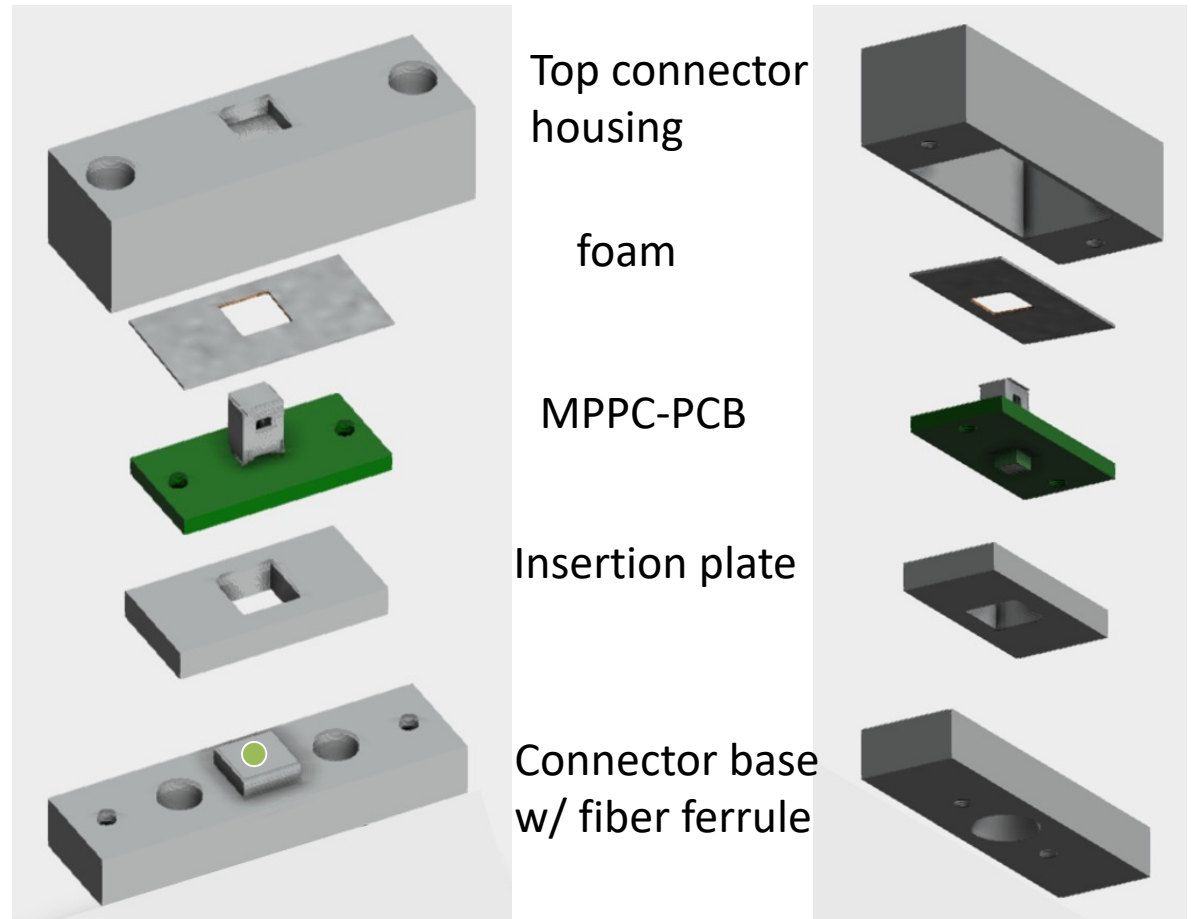

Shown is single channel connector w/o LED light injection
Concept can be expanded to 8 channels w/ LED

Modified MPPC to WLS Fiber Interface

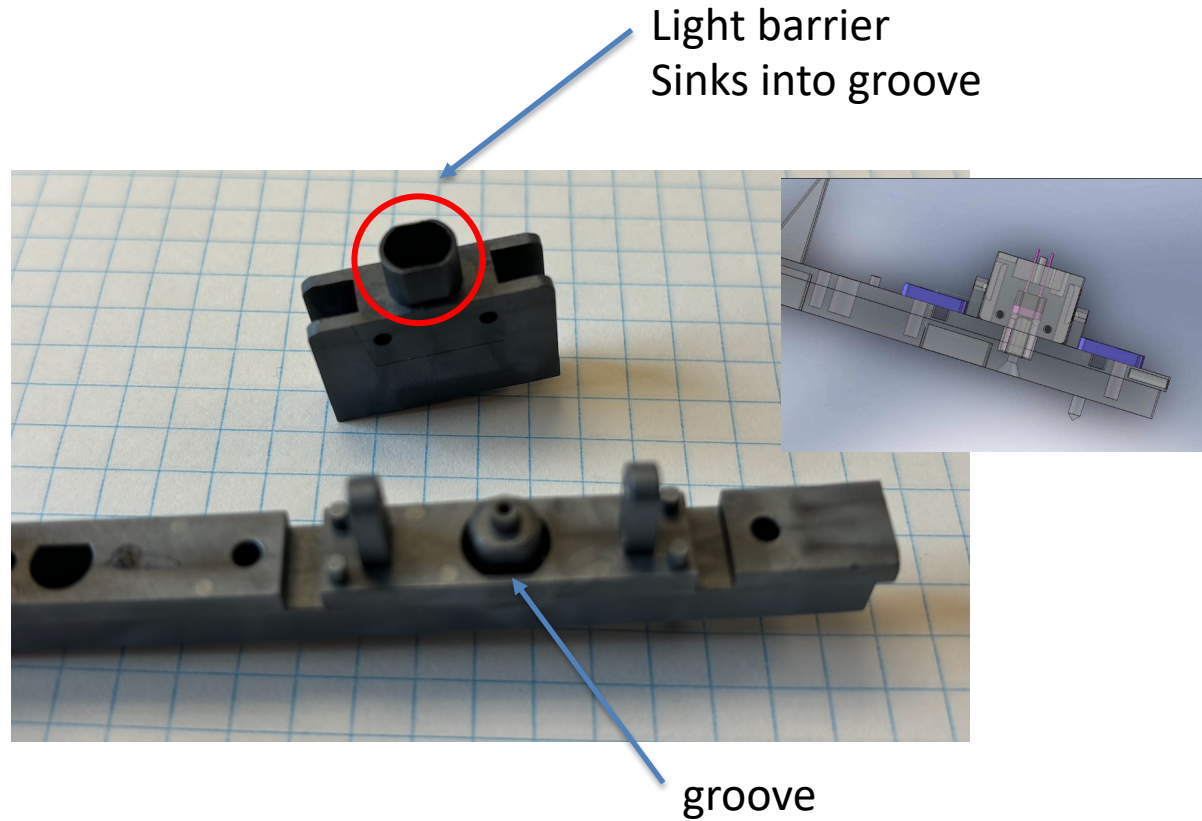
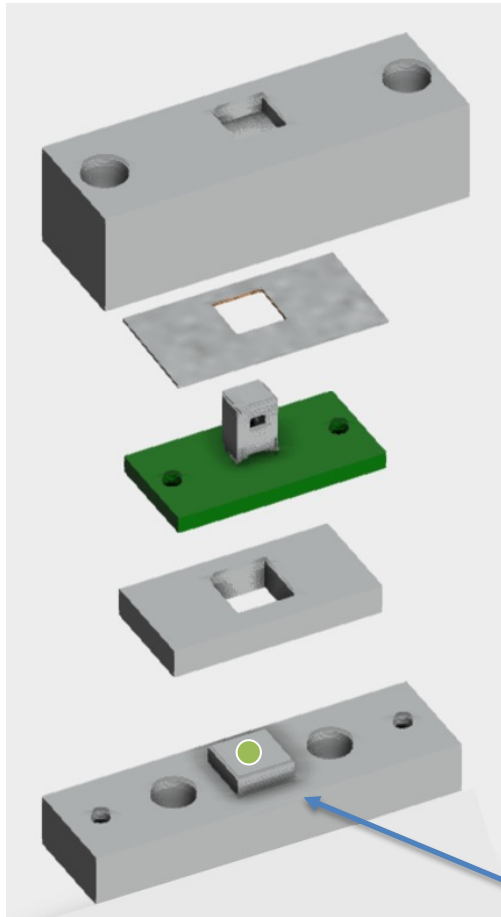

Option of adding groove around ferrule and matching light barrier on insertion plate

